



ON-VEHICLE INSPECTION

INSPECT SUNROOF GLASS ALIGNMENT

1. Start the engine and check the operating time of the sunroof (A).

Operating time: Approx. 5 secs.

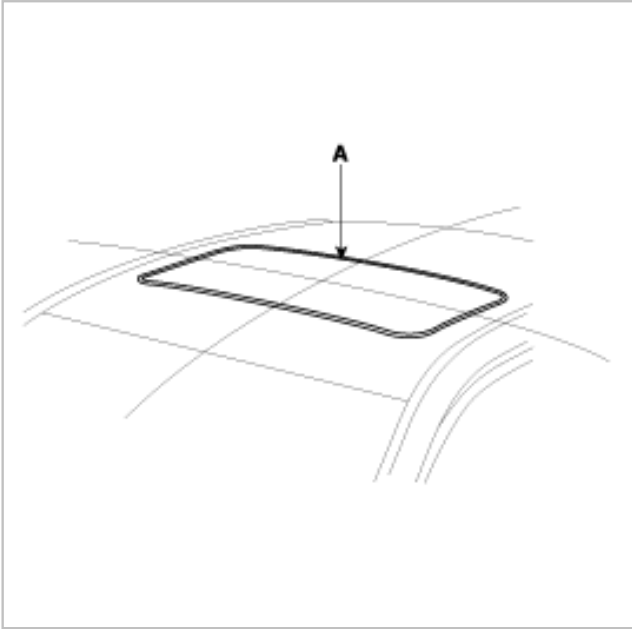

2. Check for abnormal noise or bending during operation.
3. With the sunroof fully closed, check for water leakage.
4. The roof panel (A) should be even with the glass (B) weatherstrip (C), to within the standard value "E" all the way around. If not, make the following adjustment.

Standard value "E"

Front edge: $2+0/-1$ mm (0.08+0/-0.04in.)

Rear edge: $2+1/-0$ mm (0.08+0.04/-0in.)

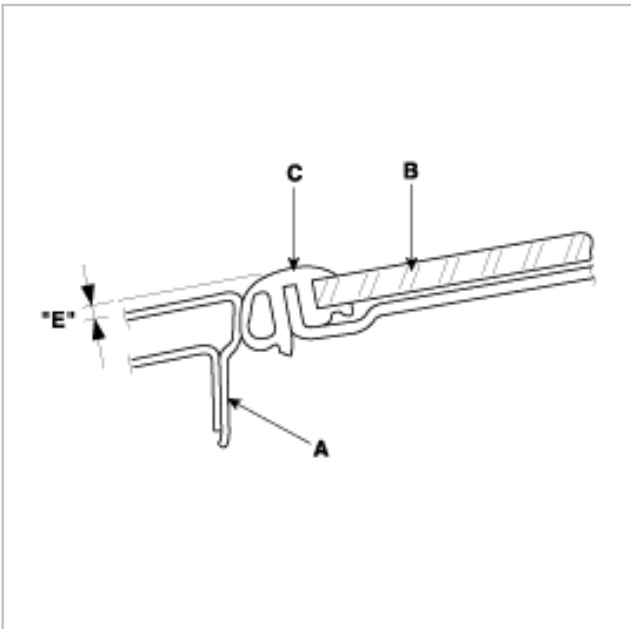

5. If the position is not as specified, lightly loosen the glass adjusting screw (A) to adjust the glass height and tighten it.

Tightening torque: 2~4Nm (20~40kgf·cm, 1.5~2.9 lbf·ft)

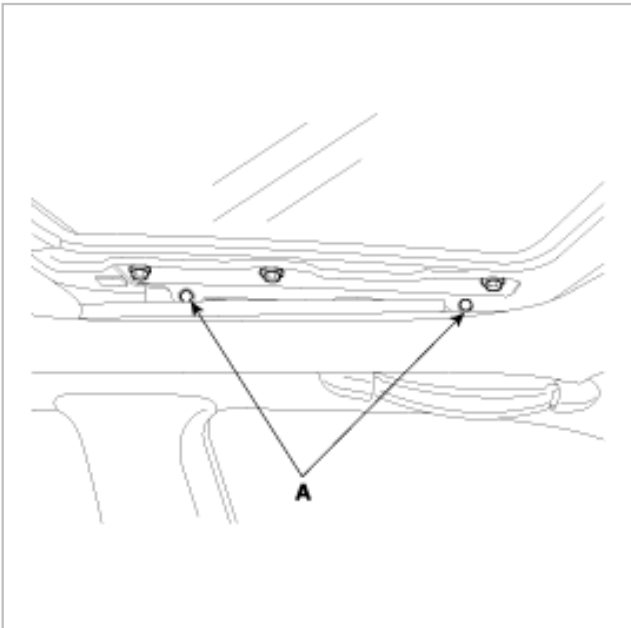

6. Check for overlap between the sunroof weatherstrip (A) and the roof panel (B).

Standard value: 1.1mm

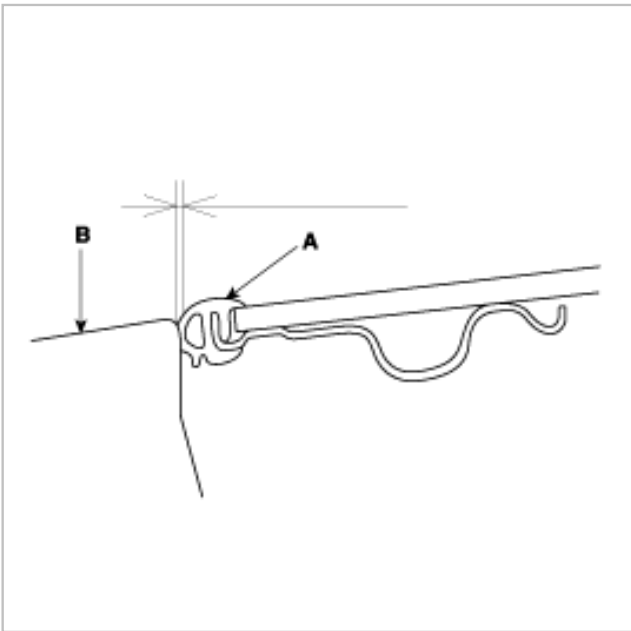

ADJUSTMENT

OPERATING THE SUNROOF EMERGENCY HANDLE

1. Use the sunroof emergency handle to close and open the sunroof manually for the following case only:
 - A. To close the sunroof before driving a vehicle in a rainy day or on the highway if the sunroof cannot be closed due to failure of the sunroof motor or controller.

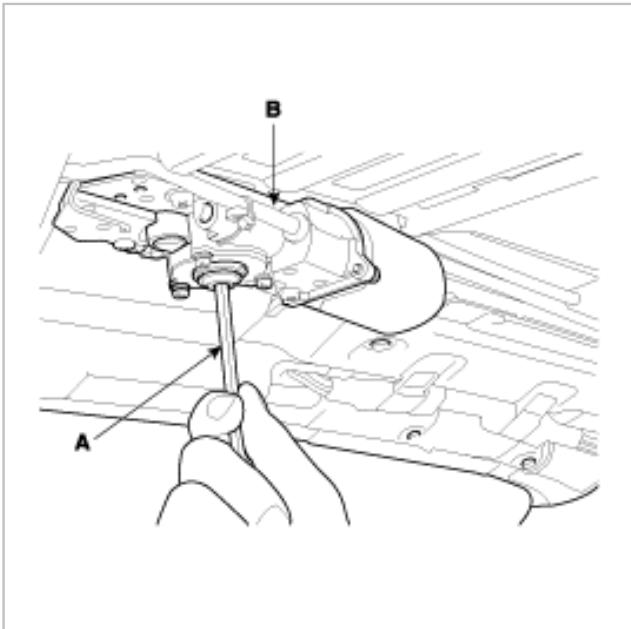

2. Operating method

- A. Remove the overhead console.
- B. Push the emergency handle up into the hexagonal drive (A) of the sunroof motor (B). You must push hard enough to disengage the motor clutch; otherwise the emergency handle will slip due to uncompletely fit in the motor.
- C. Carefully turn the emergency handle clockwise to close the sunroof.
- D. After closing the sunroof, wiggle the handle back and forth as you remove the tool from the motor, to ensure the motor clutch reengages.
- E. A 5mm hex socket may be used in place of the emergency handle, with a "Speeder" type handle.

CAUTION

Do not use power tools to operate the sunroof.
Damage to the components may occur.

REPLACEMENT

NOTE

Put on gloves to protect your hands.

GLASS REPLACEMENT

1. Close the glass fully and slide the sunshade all the way back.
2. Remove both decoration covers (A), then remove the glass mounting nuts.

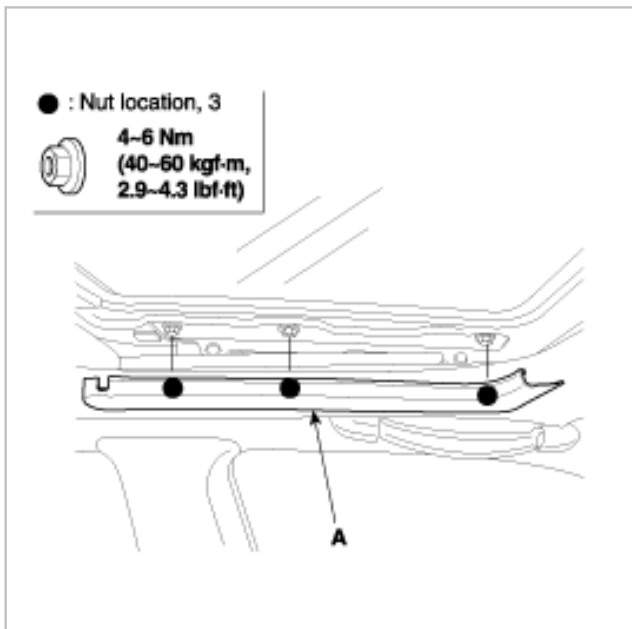

3. Remove the glass by lifting it up.

NOTE

Do not damage the roof panel.

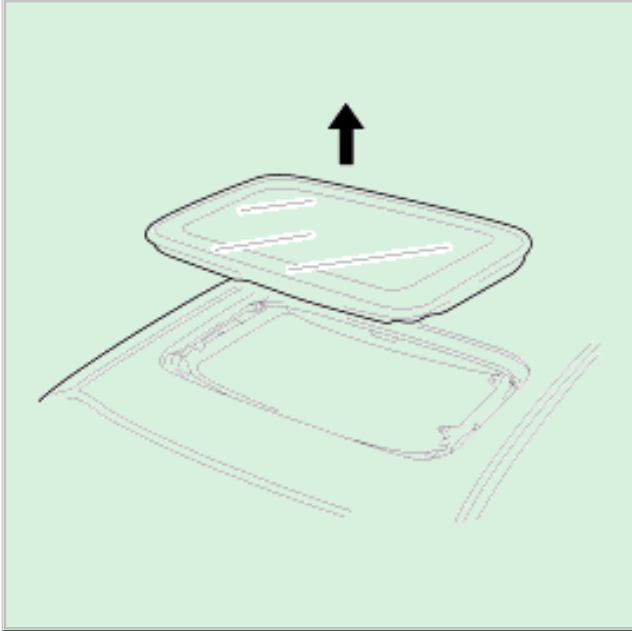

4. Installation is the reverse of removal, and adjust the glass height alignment. Check for water leaks. Do not use high-pressure water.

DRIP RAIL REPLACEMENT

1. Remove the glass.
2. After loosen the drip rail mounting screws then remove the drip rail (A).
3. Installation is the reverse of removal.

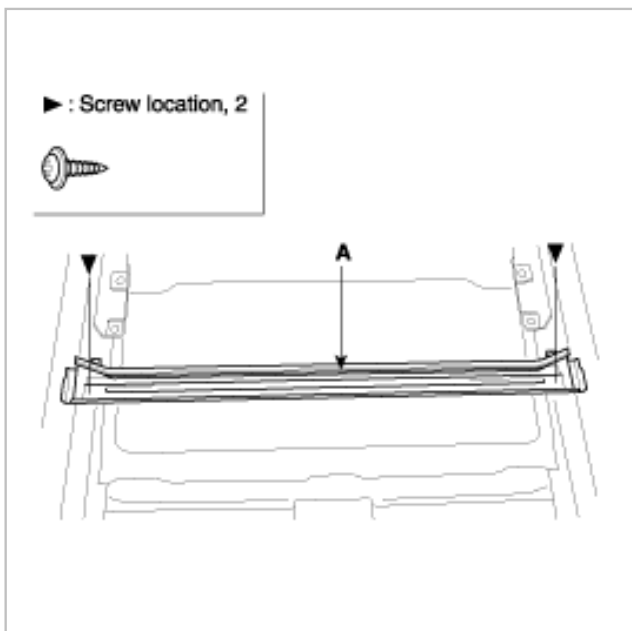

MOTOR AND CONTROLLER REPLACEMENT

1. Remove the headliner (see page BD- 66).
2. Disconnect the motor connector (A), remove the screws and then remove the motor (B).

3. Disconnect the controller connector (C), and remove the controller (D).
4. Installation is the reverse of removal.

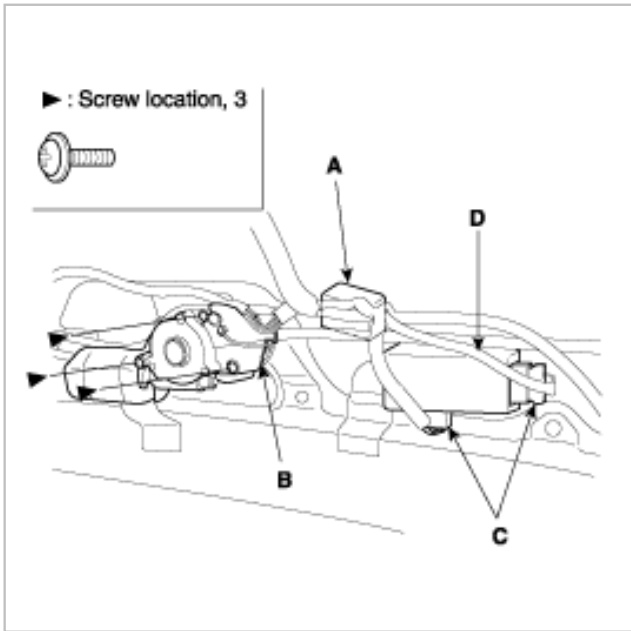

DEFLECTOR REPLACEMENT

1. Open the glass fully.
2. Disconnect the deflector link (A) from the deflector link connector (B), remove the screws, and then remove the deflector (C).
3. Installation is the reverse of removal.

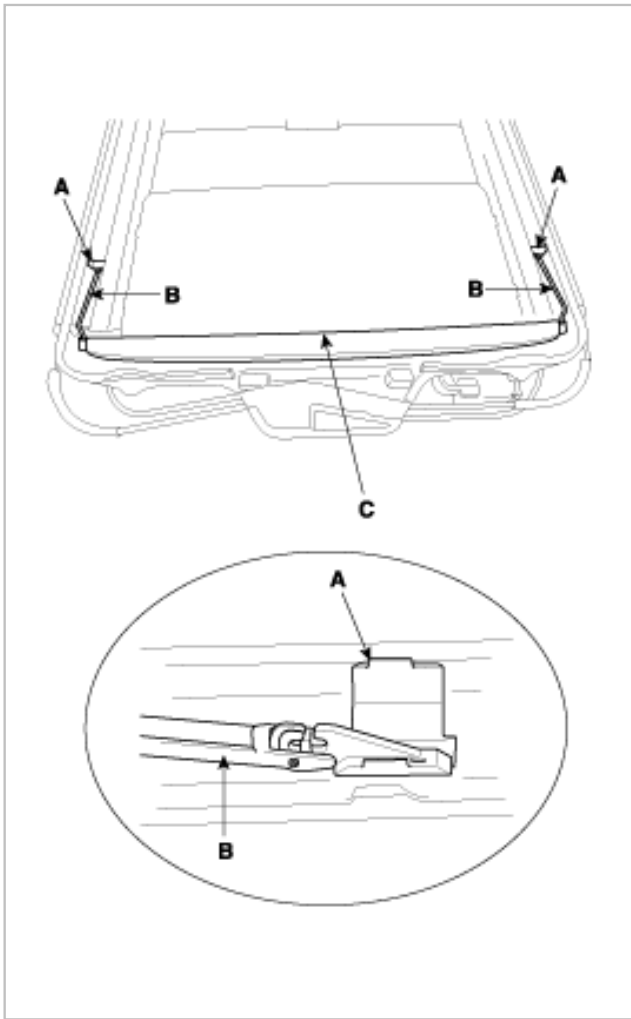

SUNSHADE REPLACEMENT

1. Remove the sunroof assembly (see page BD- 48).
2. Remove the drip rail (see page BD- 44).
3. Removing a cushion (A) and a stopper (B) mounting screw, push out the stopper backward.
4. Remove the sunshade (C).
5. Installation is the reverse of removal.

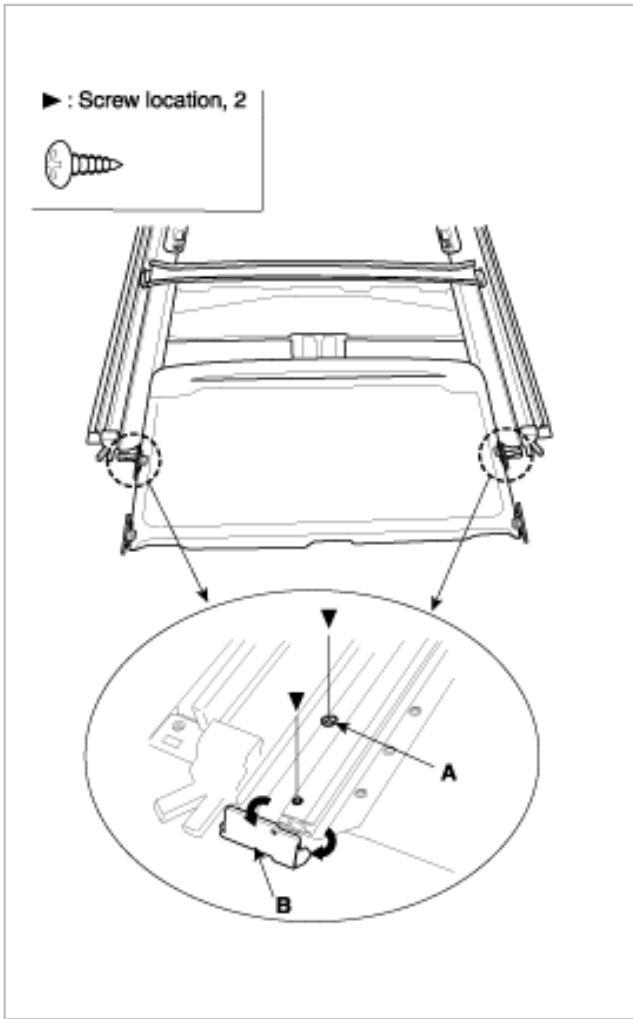

GUIDE AND SLIDER REPLACEMENT REMOVE

1. Remove the sunroof assembly (see page BD- 48).
2. Remove the drip rail. (see page BD- 44).
3. Remove the sunshade (see page BD- 46).
4. Remove the shutting (A).

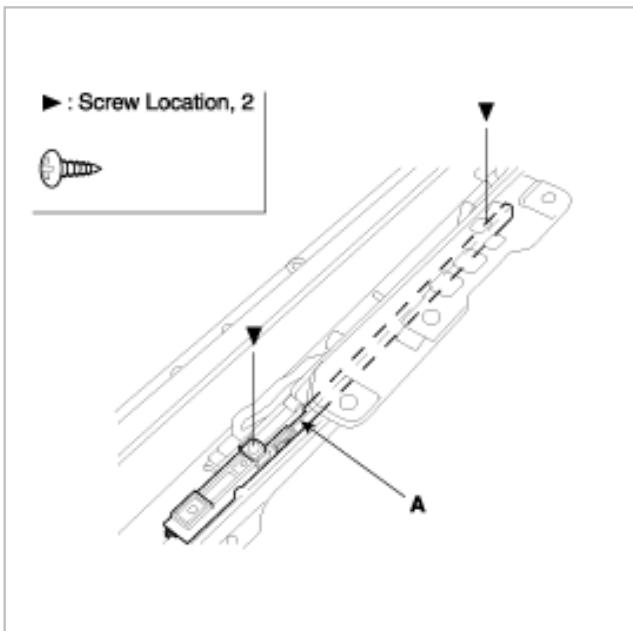

5. Remove a guide assembly (A) after lowering a guide thoroughly by pushing a slide (B) to rear.

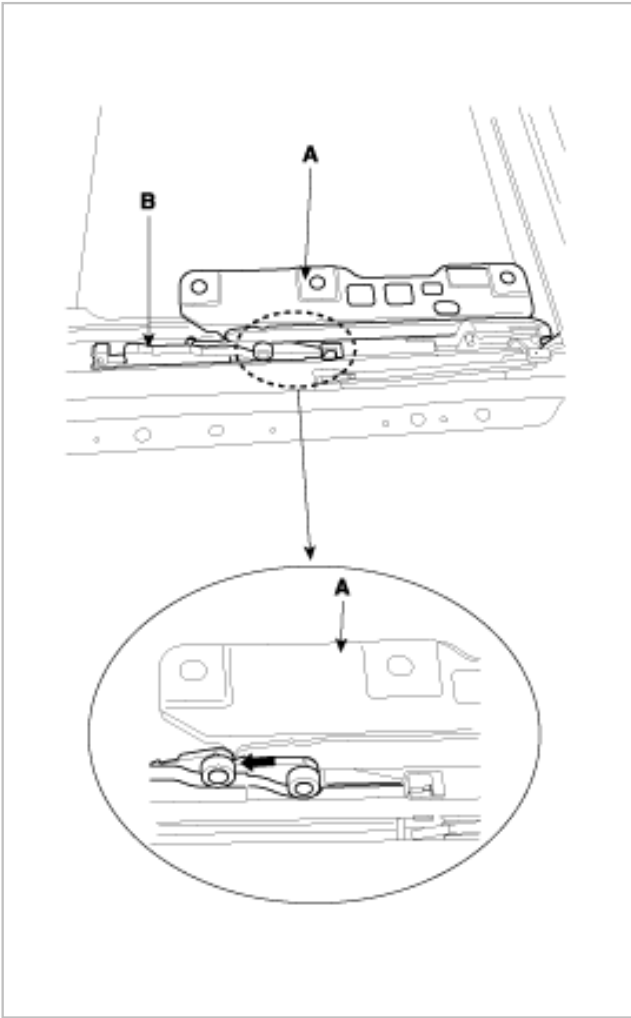

GUIDE AND SLIDER REPLACEMENT INSTALL

1. Turning a front guide assembly (A) part outward a little, insert it to rail (B).

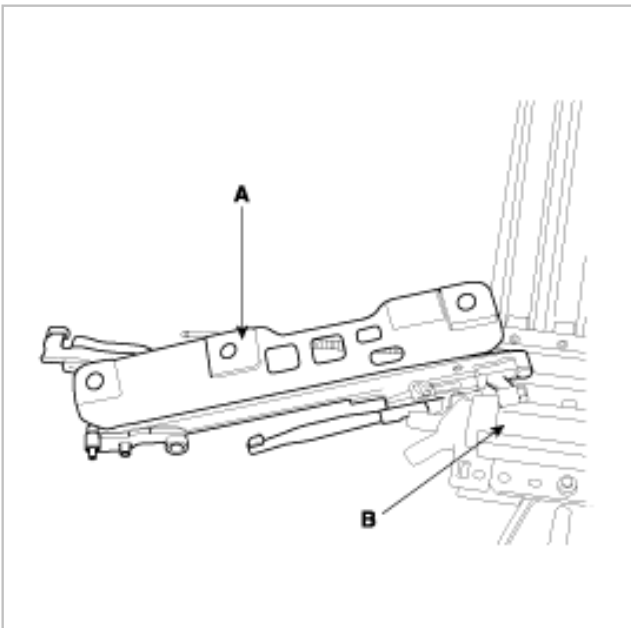

2. Connect the slide (B) to the drive cable.

3. Inserting the roller (D) of a guide assembly (A) in sliding area, install a guide assembly.

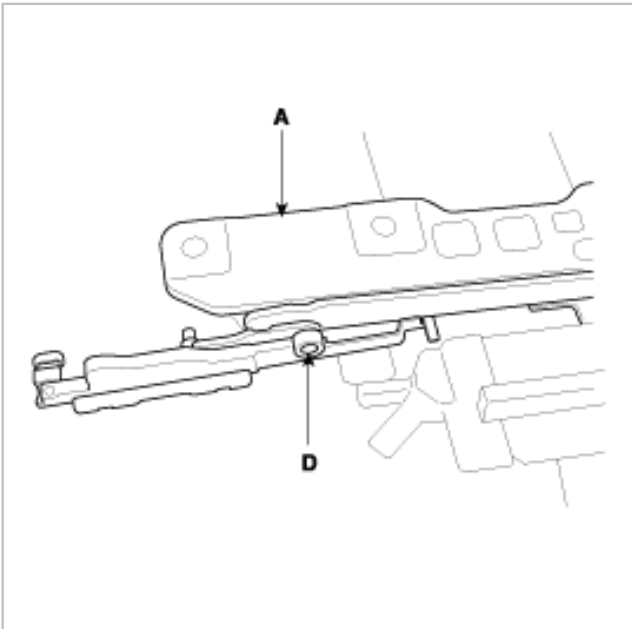

4. Install a guide assembly (A) pushing it to the end of rail and let the roller (D) of a guide assembly located in the middle of sliding area.

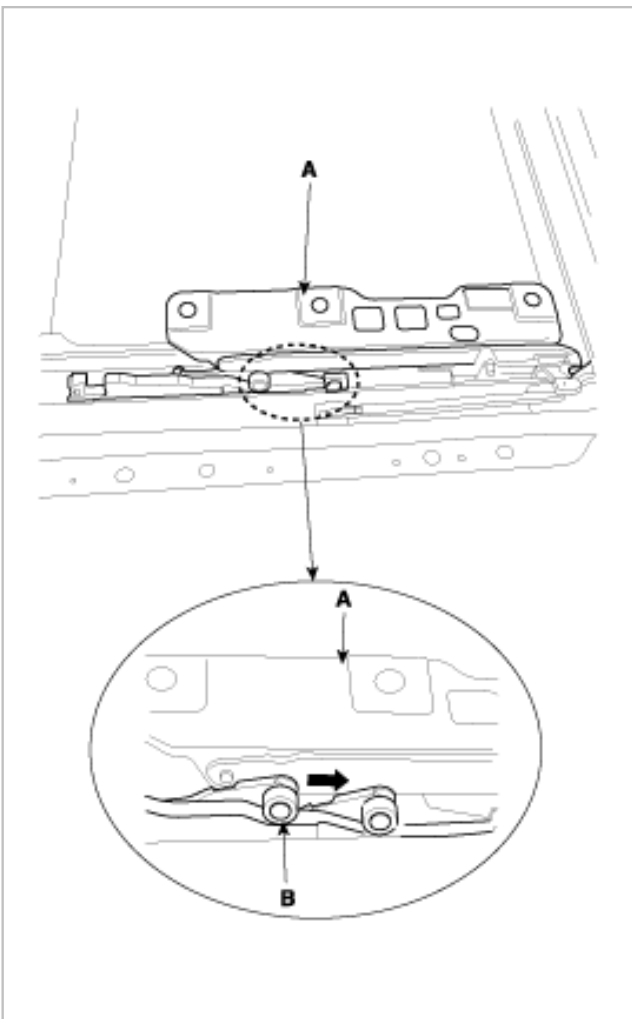

5. Inserting the shutting (A) into the sunroof rail (B), install the screws.

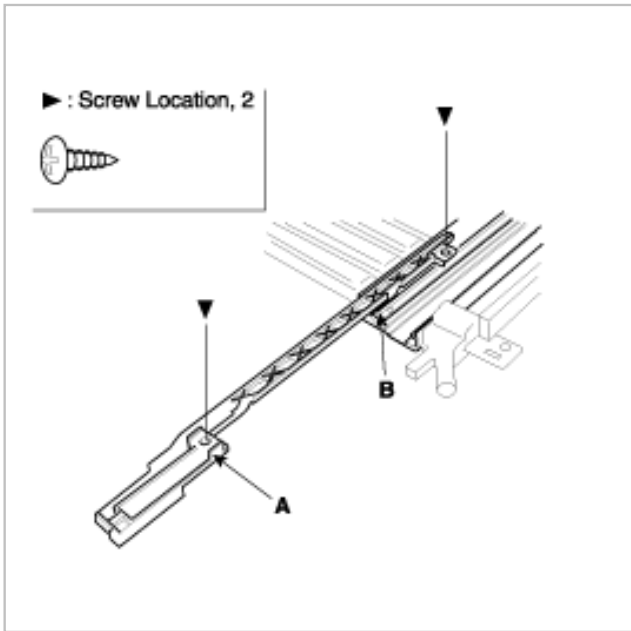

SUNROOF ASSEMBLY REPLACEMENT

1. Remove the headliner (see page BD- 66).
2. Disconnect the motor connector, sunroof switch connector, and drain tubes (A).
3. With an assistant holding the sunroof assembly (B), remove mounting bolts, and sunroof assembly.

NOTE

Take care not to scratch the interior trims and other parts.

4. Installation is the reverse of removal.

