

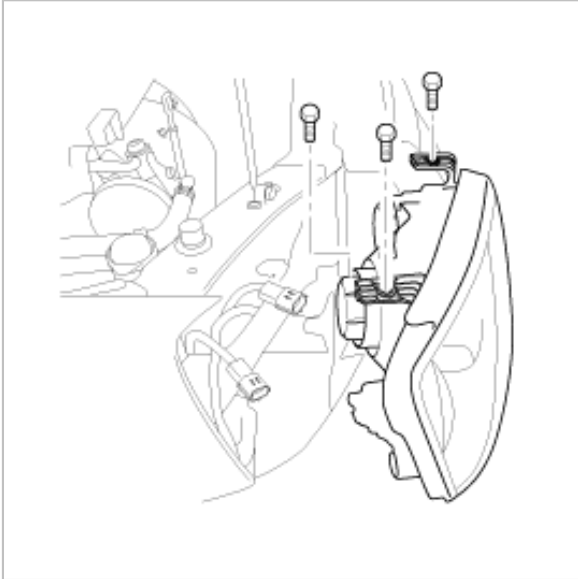

REMOVAL

1. Disconnect the negative(-) battery terminal.
2. Remove the head lamp mounting bolts (3EA), then disconnect the lamp connectors.



3. Replace the head lamp low beam bulb(A), high beam bulb(B), position bulb(C) and turn signal bulb (D).

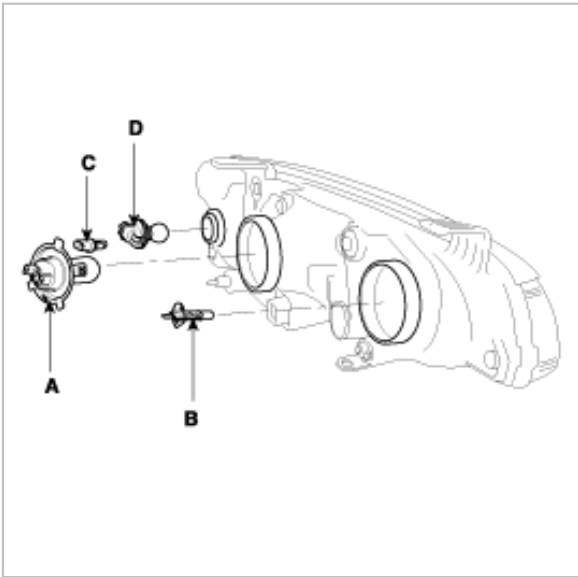

4. Installation is the reverse of removal.

AIMING INSTRUCTIONS

HEAD LAMP AIMING

NOTE

If there are any regulations pertinent to the aiming of head lamps in the area where the vehicle is to be used, adjust so as to meet those requirements.

1. Inflate the tires to the specified pressure and remove any loads from the vehicle except the driver, spare tire, and tools.
2. The vehicle should be placed on a flat floor.
3. Draw vertical lines (Vertical lines passing through respective head lamp centers) and a horizontal line (Horizontal line passing through center of head lamps) on the screen.

4. With the head lamp and battery in normal condition, aim the head lamps so the brightest portion falls on the horizontal and vertical lines.

Make vertical and horizontal adjustments to the lower beam using the adjusting wheel.

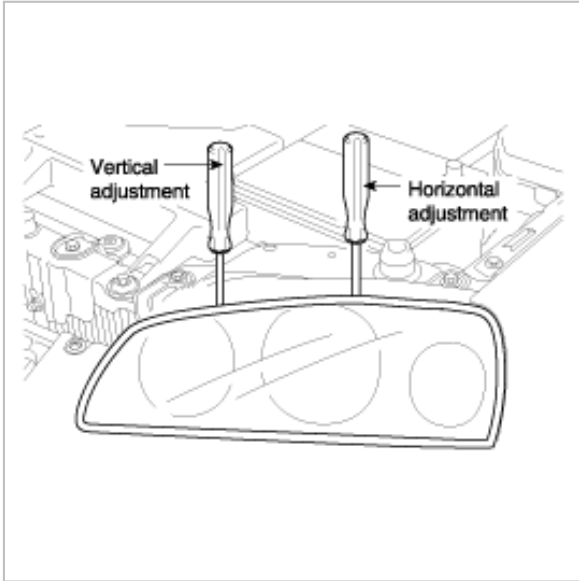

FRONT FOG LAMP AIMING

ETKA001A KTKD007B

H1 : Height between the head lamp bulb(low beam) center and ground
 H2 : Height between the fog lamp bulb center and ground

W1 : Distance between the head lamp bulb(low beam) center
 W2 : Distance between the fog lamp bulb center
 L : Distance between the head lamp bulb center and screen

HEAD LAMP AND FOG LAMP AIMING POINT

Unit : mm					
Vehicle condition	H1	H2	W1	W2	L
Without driver	651	333	1,124	1,217	3,000
With driver	639	321			

1. Turn the low beam on without driver aboard.

The cut-off line should be projected in the allowable range (shaded region).

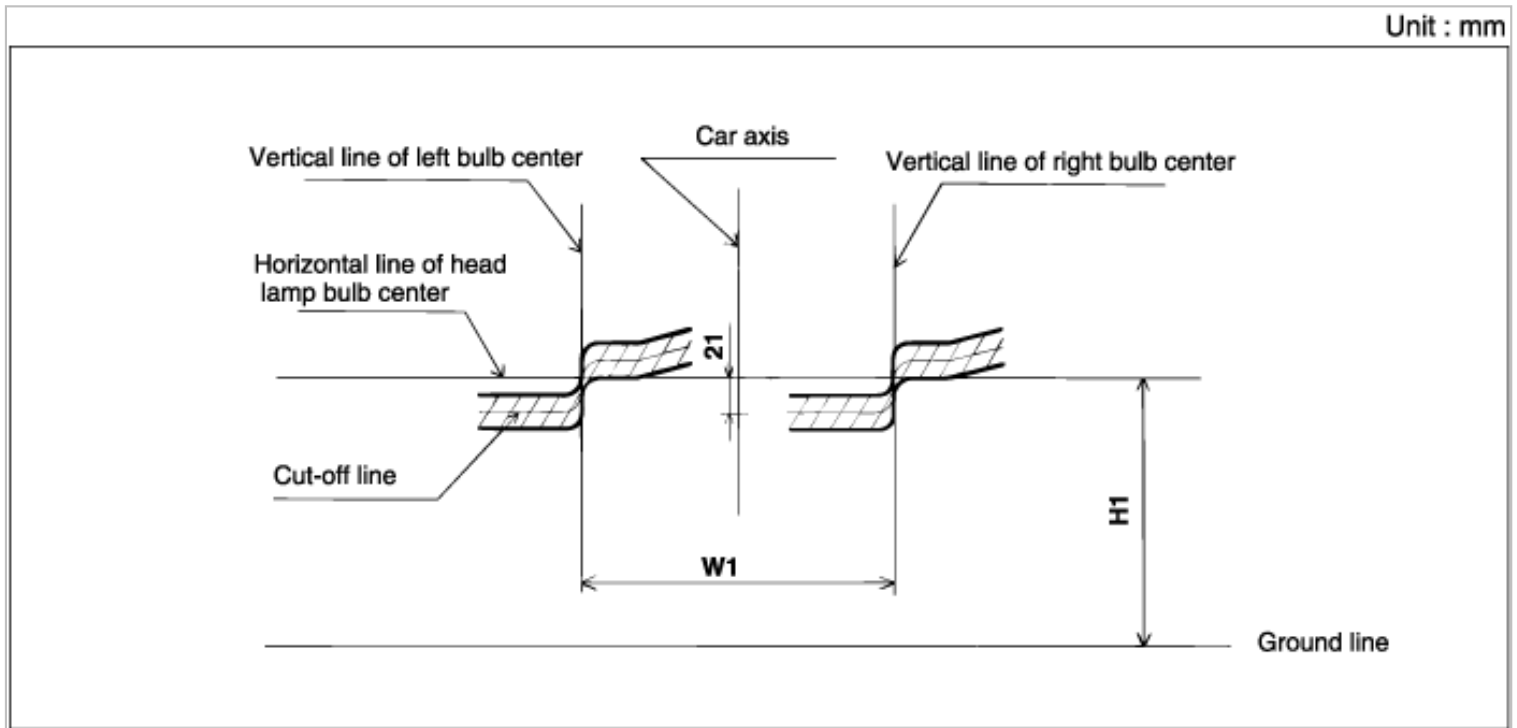

2. Turn the front fog lamp on without driver aboard.

The cut-off line should be projected in the allowable range (shaded region).

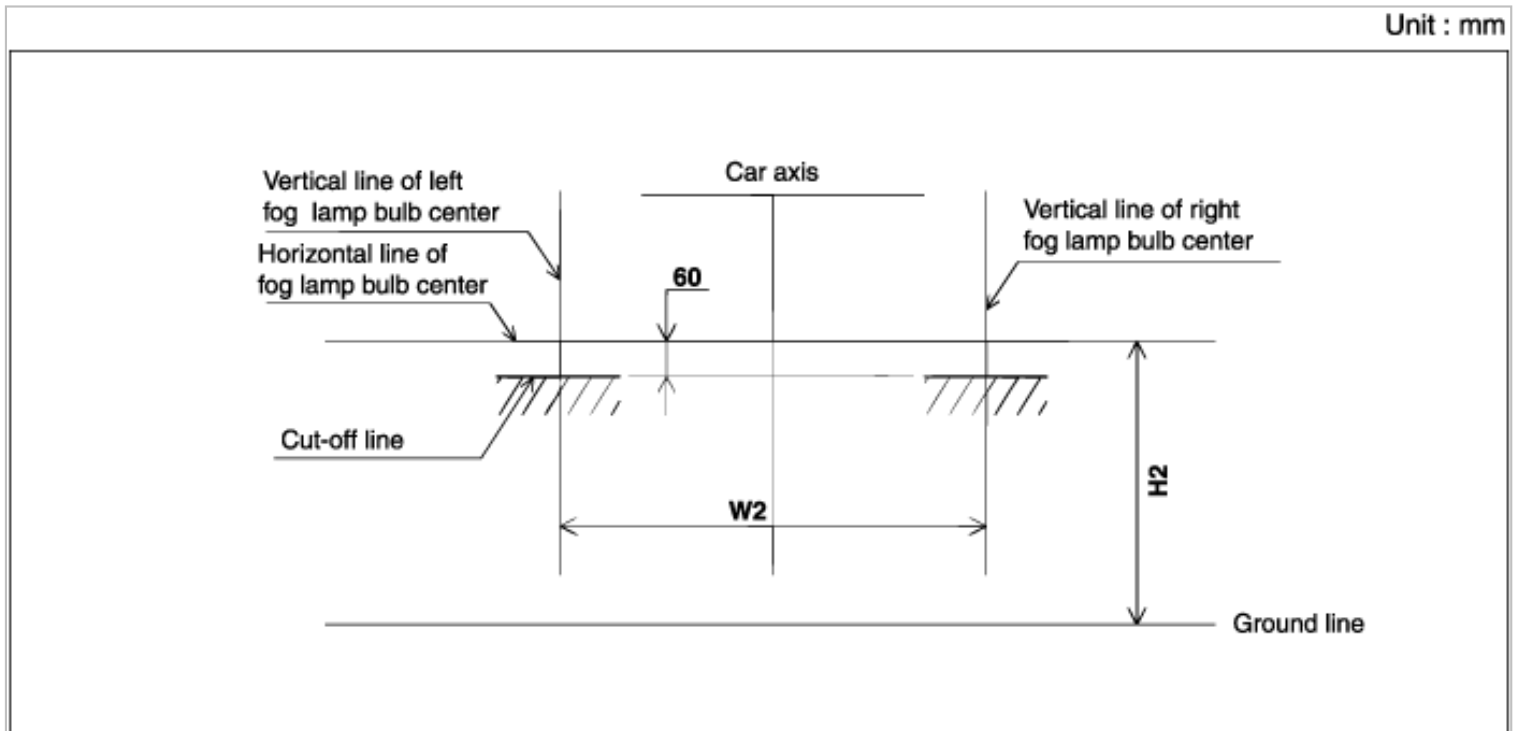

INSPECTION

HEAD LAMP RELAY

1. Pull out the head lamp relay(Low) (A) and head lamp relay (High) (B) from the engine compartment relay box.

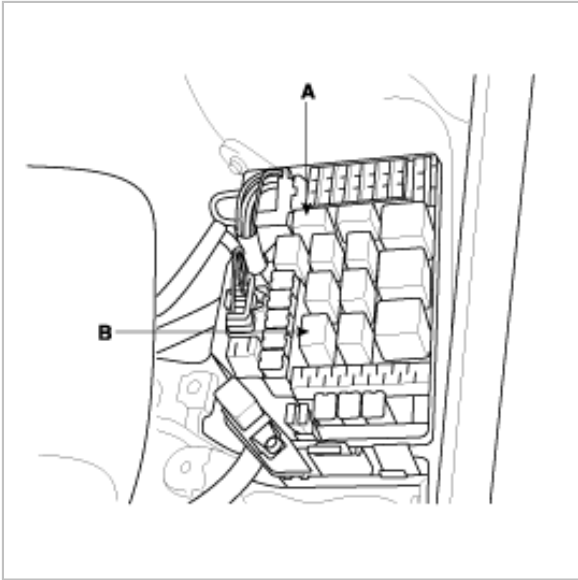

2. Check for continuity between terminals.

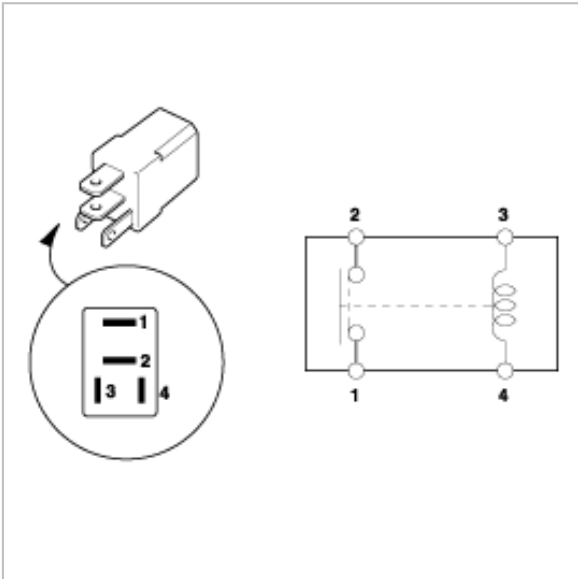

Terminal	1	2	3	4
Power (No.3-No.4)				
Disconnected			○ — ○	
Connected	○ — ○		○ — ⊕	