

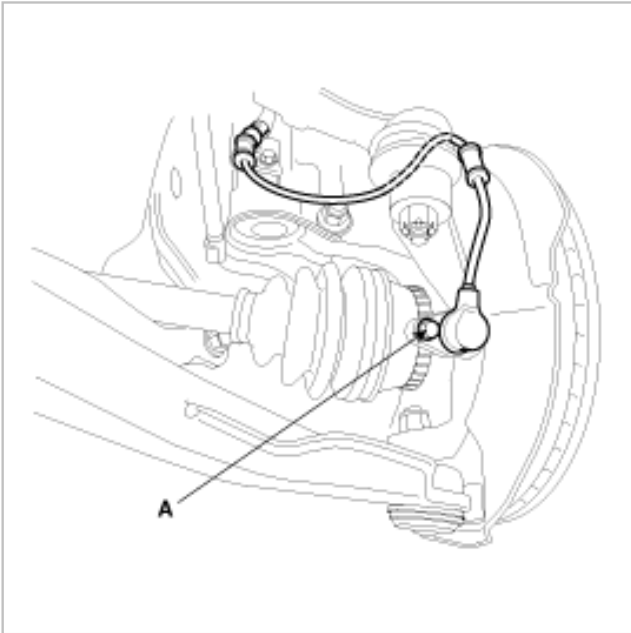

REMOVAL

FRONT WHEEL SPEED SENSOR

1. Remove the front wheel speed sensor mounting bolt (A).



2. Remove the front wheel guard (A).

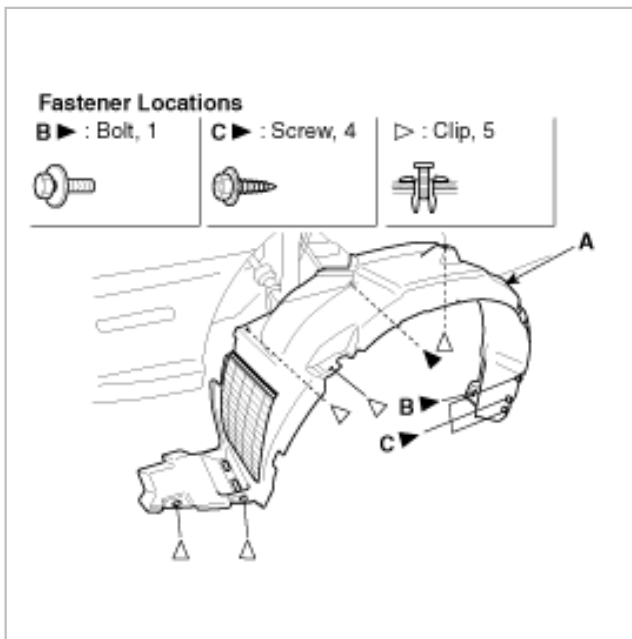

3. Remove the front wheel speed sensor after disconnecting the wheel speed sensor connector (A).

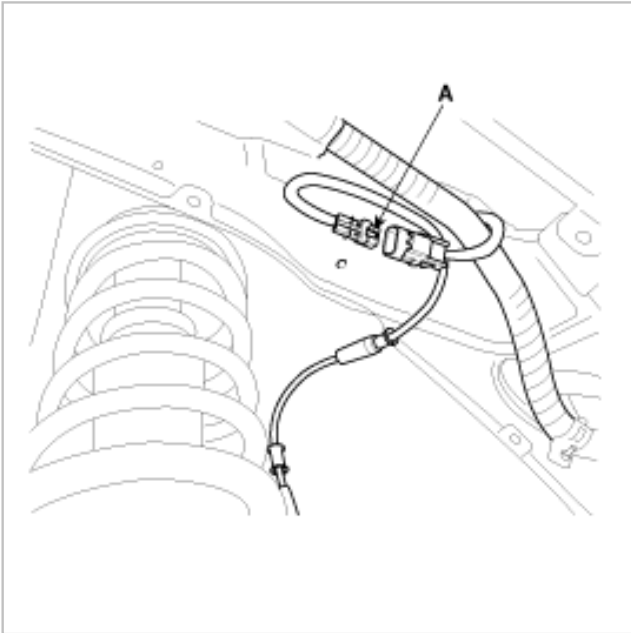

REAR WHEEL SPEED SENSOR

1. Remove the rear wheel speed sensor mounting bolt (A).

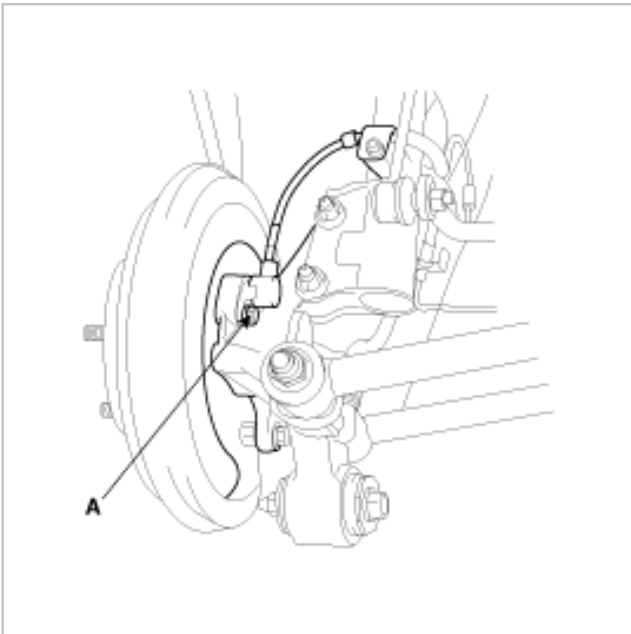

2. Remove the rear seat side pad then disconnect the rear wheel speed sensor connector (A).

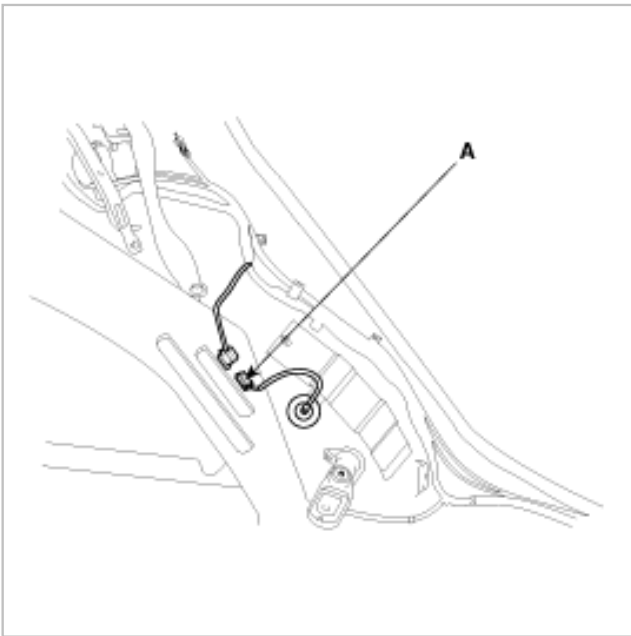

INSPECTION

1. Connect an ohmmeter between the wheel speed sensor terminals and measure the resistance.

Service standard

Front : 1275 ~ 1495

Rear : 1275 ~ 1495

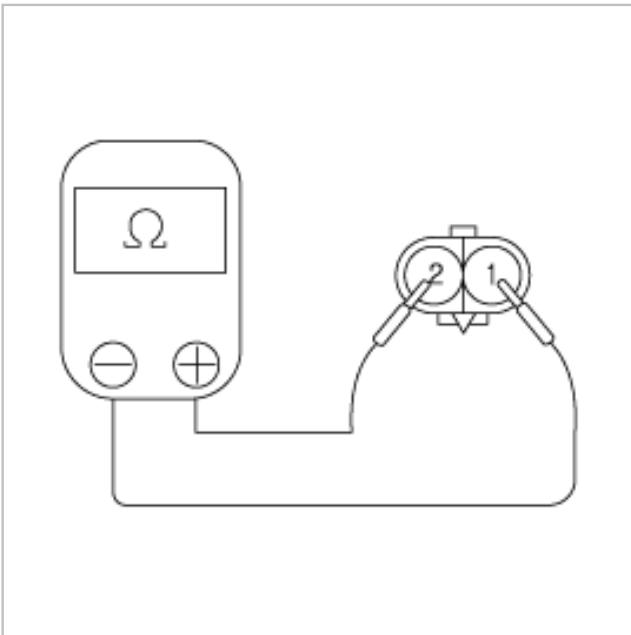

2. Connect a voltmeter between the wheel speed sensor terminals and measure the voltage by turning the wheel.

NOTE

Set the voltmeter to measure AC voltage.

Service standard: AC voltage detected.

