



Brake Pedal and Brake Switch Adjustment

Pedal Height

1. Disconnect the brake switch connector, loosen the brake switch locknut (A), and back off the brake switch (B) until it is no longer touching the brake pedal.
2. Lift up the carpet. At the insulator cutout, measure the pedal height (C) from the middle of the left-side center of the pedal pad (D).

135 mm (5.31 in.)

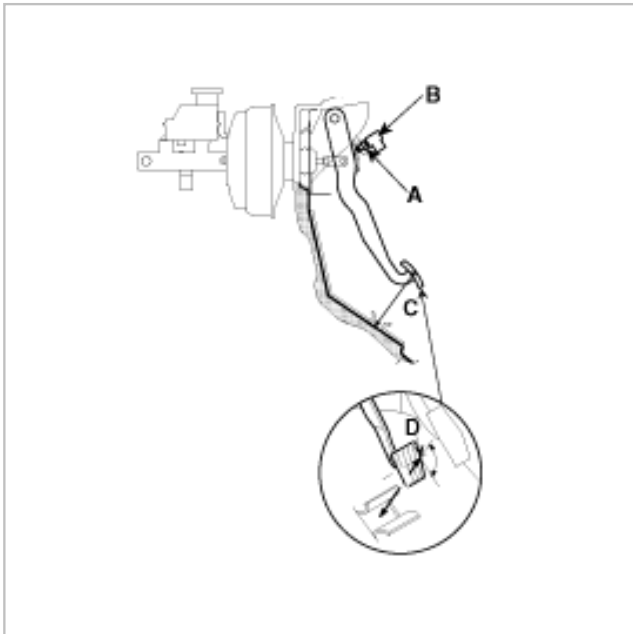

3. Loosen the pushrod locknut (A), and screw the pushrod in or out with pliers until the standard pedal height from the floor is reached. After adjustment, tighten the locknut firmly. Do not adjust the pedal height with the pushrod depressed.

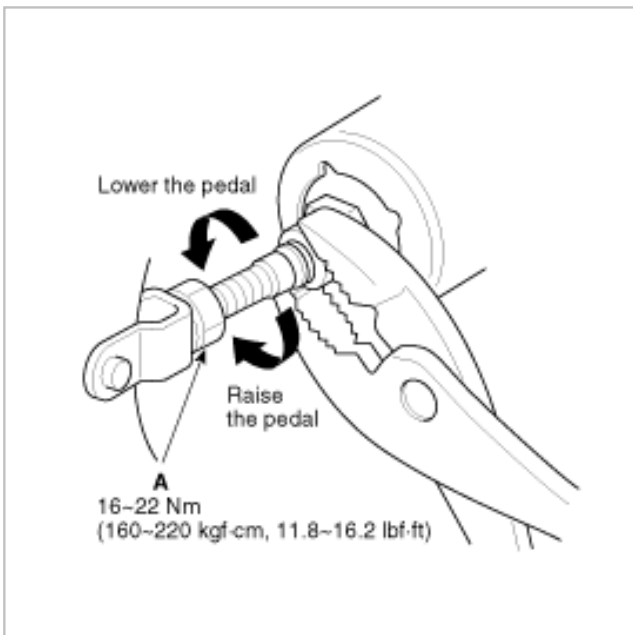

BRAKE SWITCH CLEARANCE

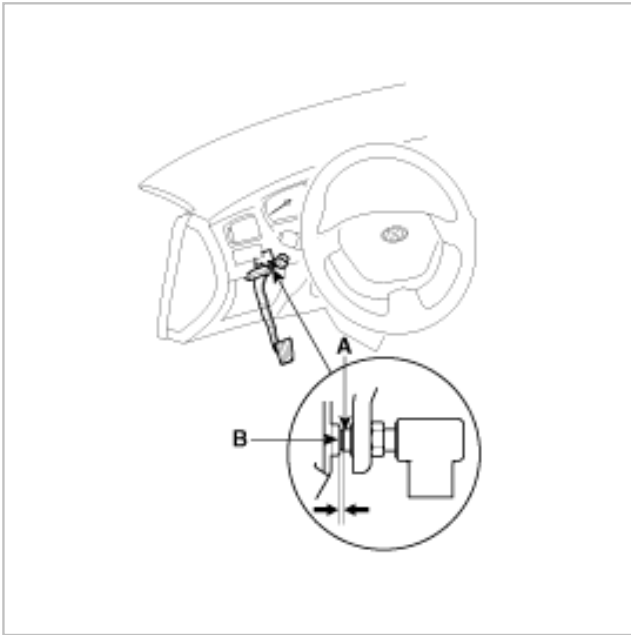

Pedal Free Play

1. With the engine off, inspect the pedal free play (A) on the pedal pad (B) by pushing the pedal by hand.

3~8 mm (0.11~0.31in.)

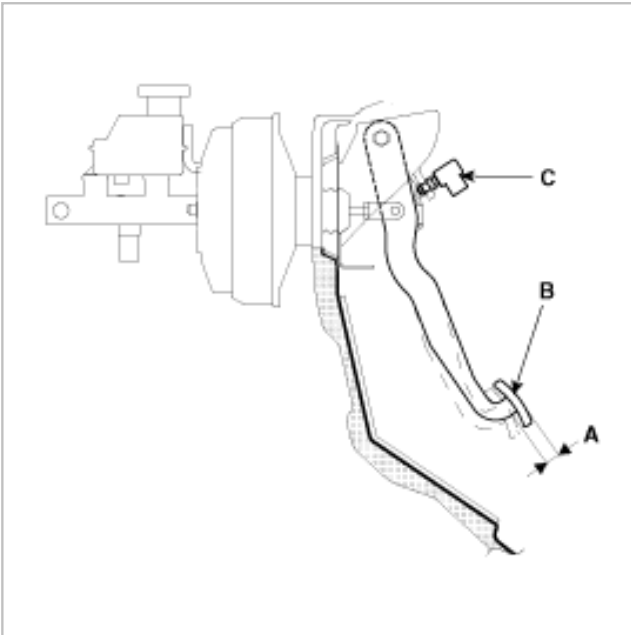

2. If the pedal free play is out of specification, adjust the brake switch (C). If the pedal free play is insufficient, it may result in brake drag.

Parking brake check and adjustment

Check

1. Pull the parking brake lever (A) with 196 N (20 kgf, 44 lbf) force to fully apply the parking brake. The parking brake lever should be locked within the specified number of clicks (B)

Lever locked clicks:

Vehicle with rear disc brakes: 8~9

Vehicle with rear drum brakes: 8

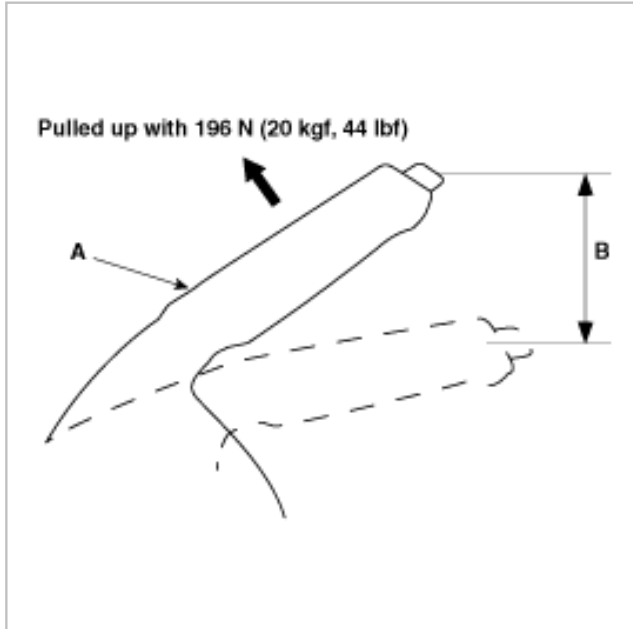

2. Adjust the parking brake if the lever clicks are out of specification.

ADJUSTMENT

NOTE

After rear brake caliper servicing, loosen the parking brake adjusting nut, start the engine and depress the brake pedal several times to set the self-adjusting brake before adjusting the parking brake.

1. Block the front wheels, then raise the rear of the vehicle and make sure it is securely supported.
2. Make sure the parking brake arm (A) on the rear brake caliper contacts the brake caliper pin (B).

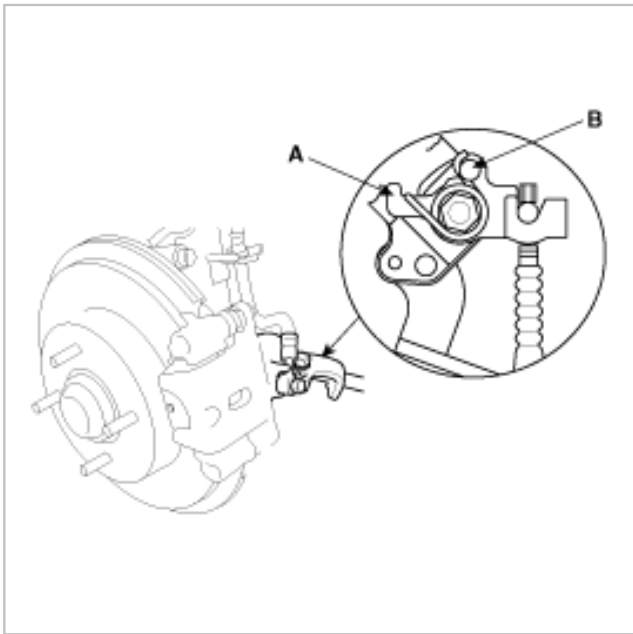

3. Pull the parking brake lever up one click.

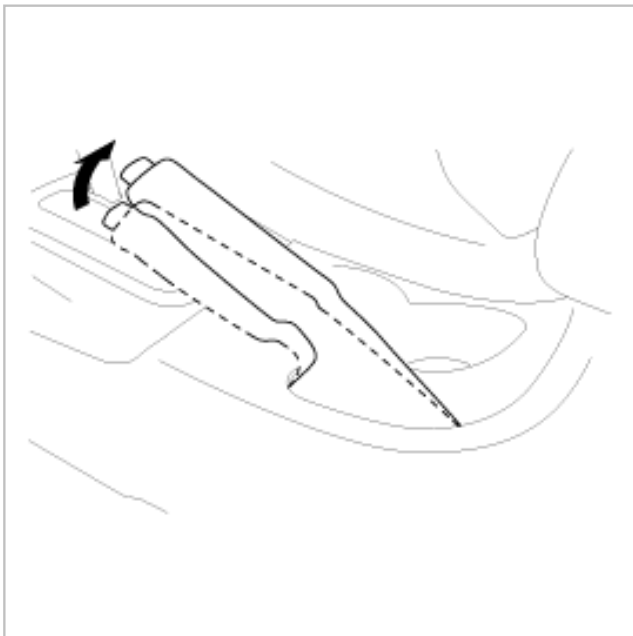

4. Remove the console (See page BD).

5. Tighten the adjusting nut (A) until the parking brakes drag slightly when the rear wheels are turned.

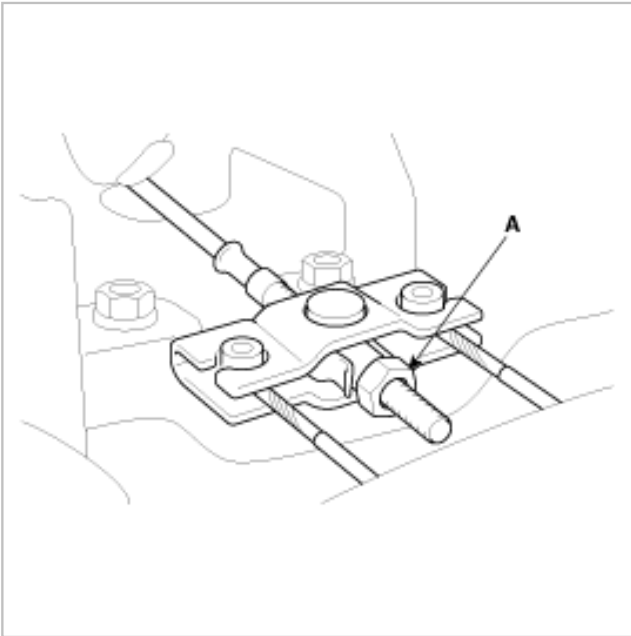

6. Release the parking brake lever fully, and check that parking brakes do not drag when the rear wheels are turned. Readjust if necessary.
7. Make sure that the parking brakes are fully applied when the parking brake lever is pulled up fully.
8. Reinstall the console.

Brake System Bleeding

NOTE

- Do not reuse the drained fluid.
- Always use Genuine DOT 3 or DOT 4 Brake Fluid. Using a non-Genuine DOT3 or DOT 4 brake fluid can cause corrosion and decrease the life of the system.
- Make sure no dirt or other foreign matter is allowed to contaminate the brake fluid.
- Do not spill brake fluid on the vehicle, it may damage the paint; if brake fluid does contact the paint, wash it off immediately with water.
- The reservoir on the master cylinder must be at the MAX (upper) level mark at the start of bleeding procedure and checked after bleeding each brake caliper. Add fluid as required.

1. Make sure the brake fluid level in the reservoir is at the MAX (upper) level line (A).

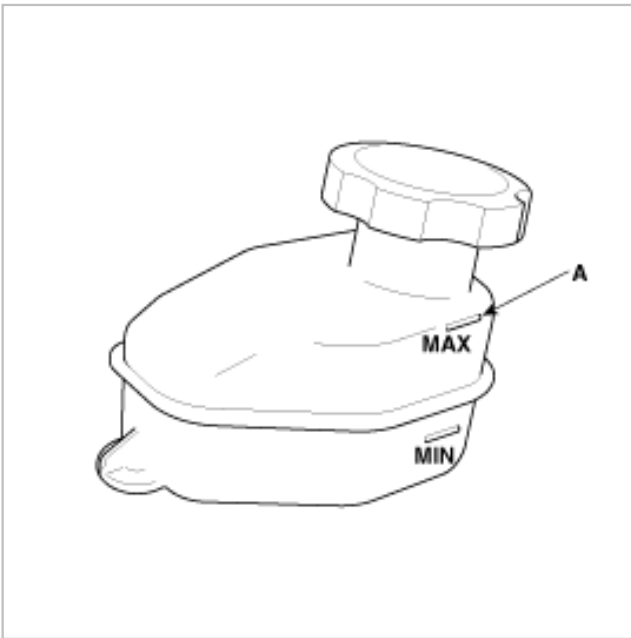

2. Have someone slowly pump the brake pedal several times, then apply steady pressure.
3. Loosen the right-rear brake bleed screw to allow air to escape from the system. Then tighten the bleed screw securely.
4. Repeat the procedure for each wheel in the sequence shown below until air bubbles no longer appear in the fluid.
5. Refill the master cylinder reservoir to the MAX (upper) level line.

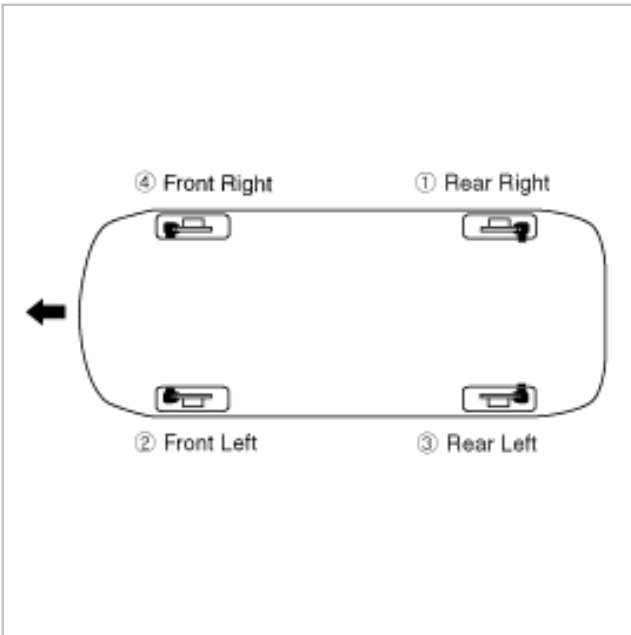

Front disc brake:

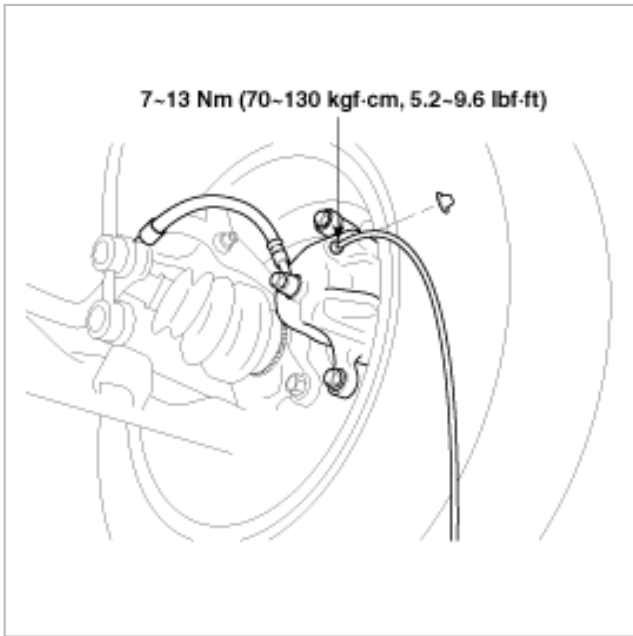

Rear disc brake:

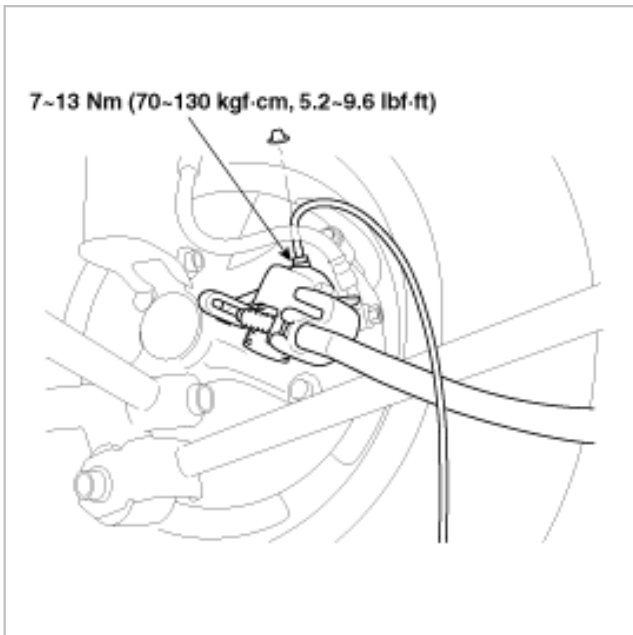

Rear drum brake:

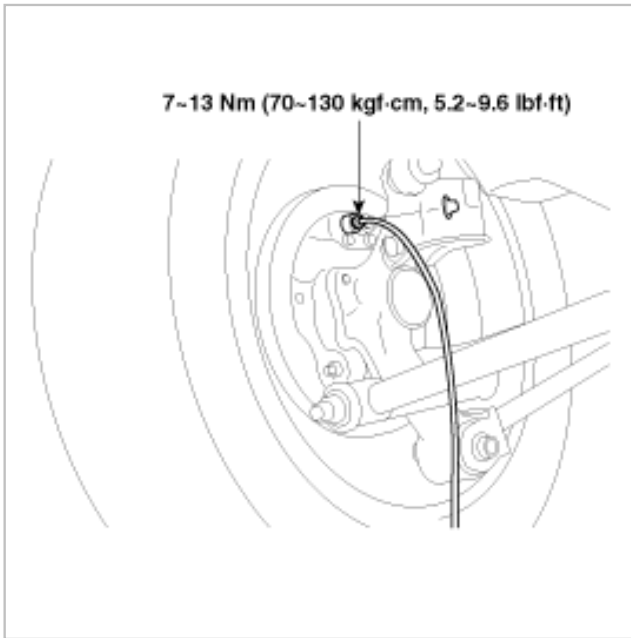

Parking Brake Switch Test

1. Remove the rear console, and disconnect the connector (A) from the switch (B).

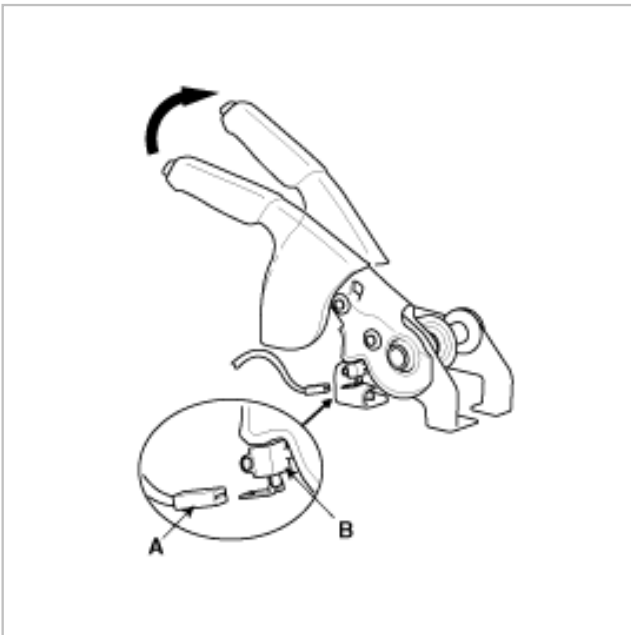

2. Check for continuity between the positive terminal and body ground:
 - A. With the brake lever up, there should be continuity.
 - B. With the brake lever down, there should be no continuity.

Brake Pedal and Brake Switch Adjustment

Pedal Height

1. Disconnect the brake switch connector, loosen the brake switch locknut (A), and back off the brake switch (B) until it is no longer touching the brake pedal.

2. Lift up the carpet. At the insulator cutout, measure the pedal height (C) from the middle of the left-side center of the pedal pad (D).

135 mm (5.31 in.)

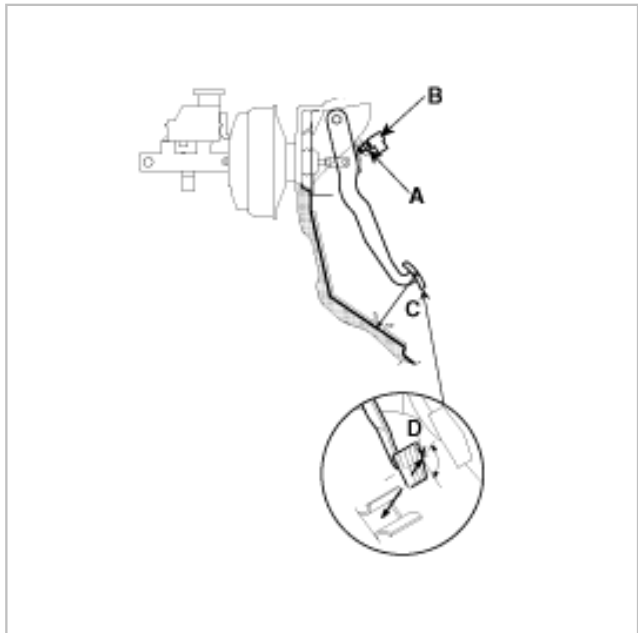

3. Loosen the pushrod locknut (A), and screw the pushrod in or out with pliers until the standard pedal height from the floor is reached. After adjustment, tighten the locknut firmly. Do not adjust the pedal height with the pushrod depressed.

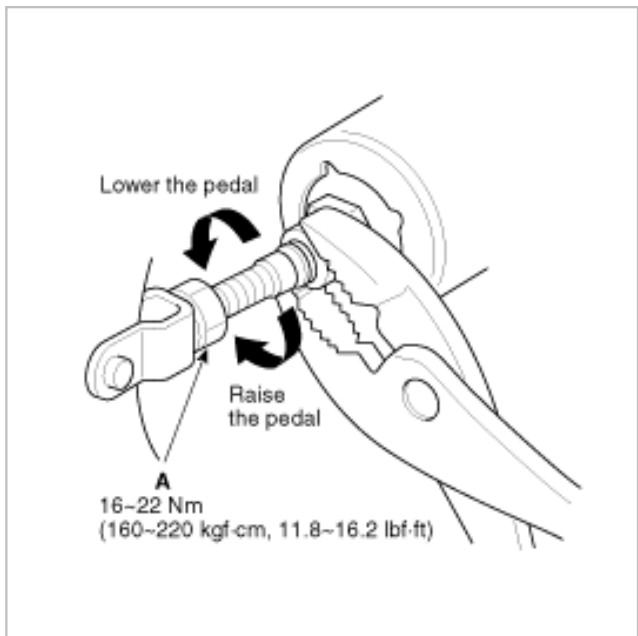

BRAKE SWITCH CLEARANCE

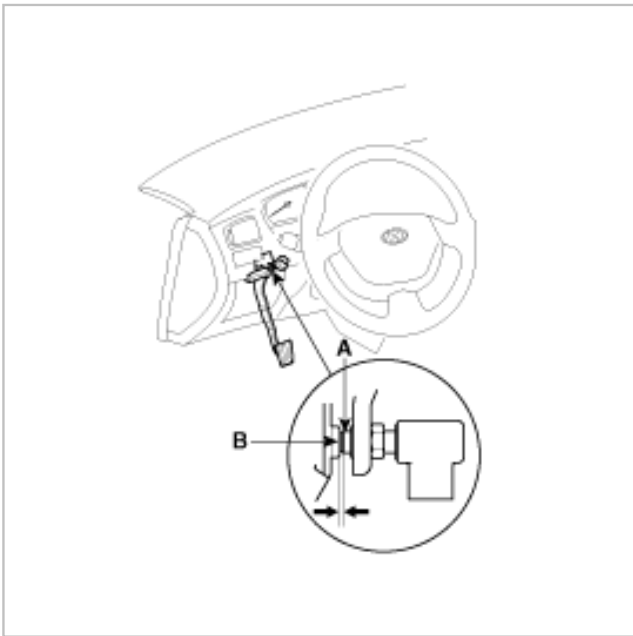

Pedal Free Play

1. With the engine off, inspect the pedal free play (A) on the pedal pad (B) by pushing the pedal by hand.

3~8 mm (0.11~0.31in.)

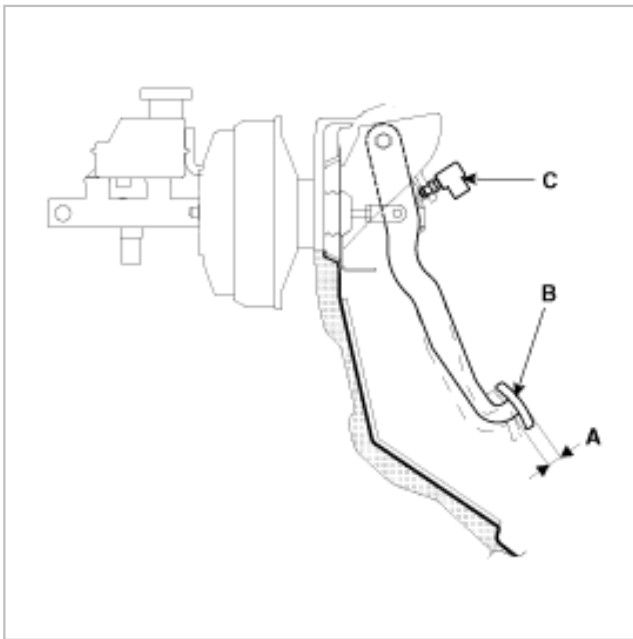

2. If the pedal free play is out of specification, adjust the brake switch (C). If the pedal free play is insufficient, it may result in brake drag.

Parking brake check and adjustment

Check

1. Pull the parking brake lever (A) with 196 N (20 kgf, 44 lbf) force to fully apply the parking brake. The parking brake lever should be locked within the specified number of clicks (B)

Lever locked clicks:

Vehicle with rear disc brakes: 8~9

Vehicle with rear drum brakes: 8

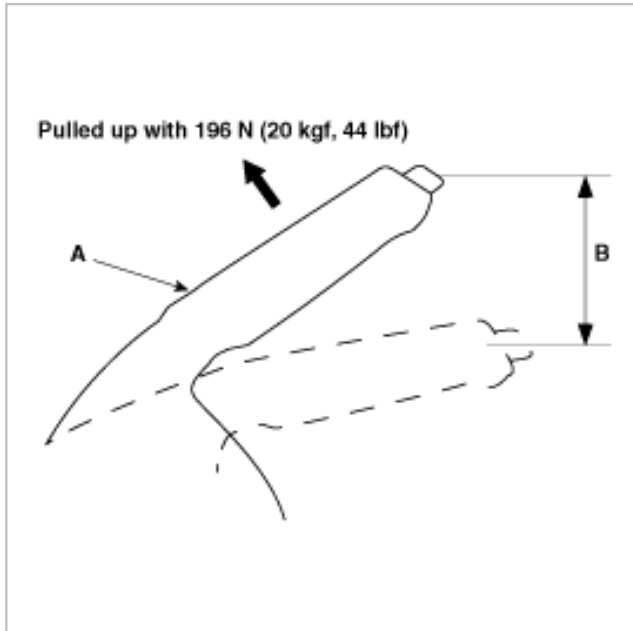

2. Adjust the parking brake if the lever clicks are out of specification.

ADJUSTMENT

NOTE

After rear brake caliper servicing, loosen the parking brake adjusting nut, start the engine and depress the brake pedal several times to set the self-adjusting brake before adjusting the parking brake.

1. Block the front wheels, then raise the rear of the vehicle and make sure it is securely supported.
2. Make sure the parking brake arm (A) on the rear brake caliper contacts the brake caliper pin (B).

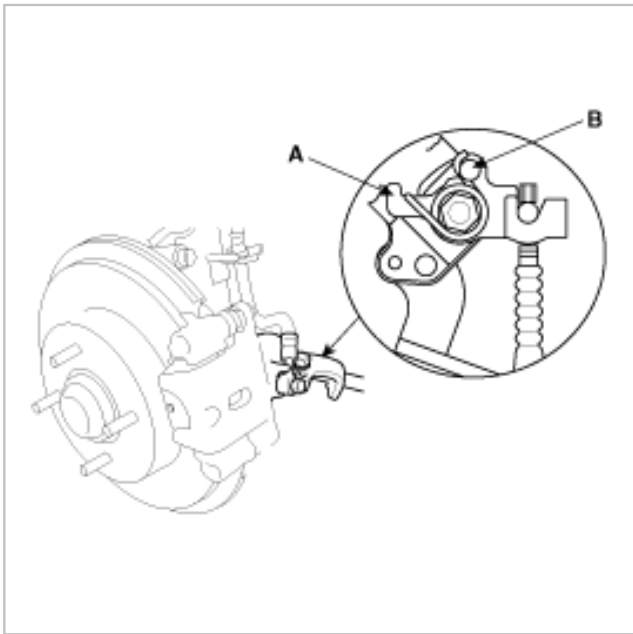

3. Pull the parking brake lever up one click.

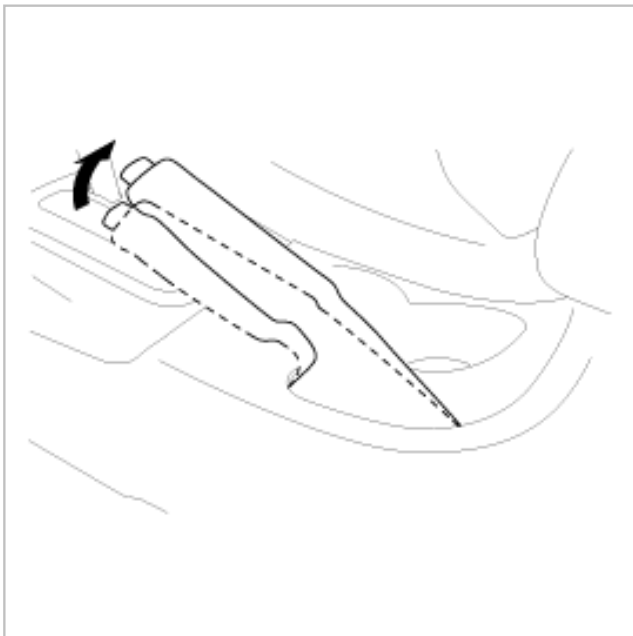

4. Remove the console (See page BD).

5. Tighten the adjusting nut (A) until the parking brakes drag slightly when the rear wheels are turned.

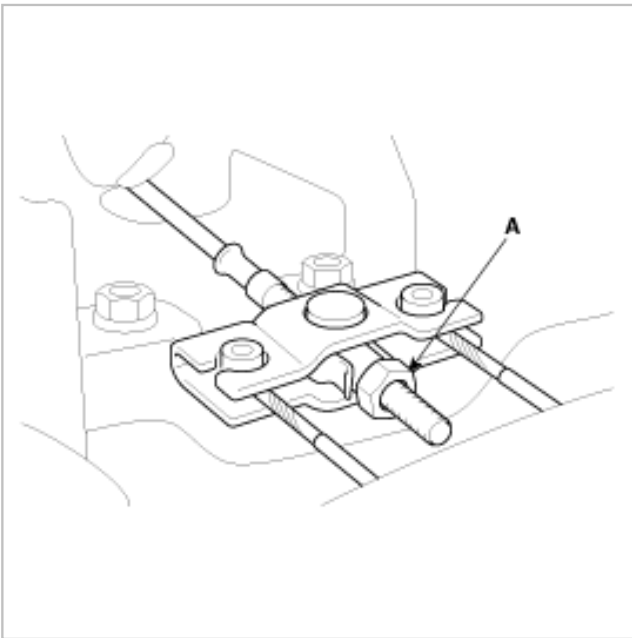

6. Release the parking brake lever fully, and check that parking brakes do not drag when the rear wheels are turned. Readjust if necessary.
7. Make sure that the parking brakes are fully applied when the parking brake lever is pulled up fully.
8. Reinstall the console.

Brake System Bleeding

NOTE

- Do not reuse the drained fluid.
- Always use Genuine DOT 3 or DOT 4 Brake Fluid. Using a non-Genuine DOT3 or DOT 4 brake fluid can cause corrosion and decrease the life of the system.
- Make sure no dirt or other foreign matter is allowed to contaminate the brake fluid.
- Do not spill brake fluid on the vehicle, it may damage the paint; if brake fluid does contact the paint, wash it off immediately with water.
- The reservoir on the master cylinder must be at the MAX (upper) level mark at the start of bleeding procedure and checked after bleeding each brake caliper. Add fluid as required.

1. Make sure the brake fluid level in the reservoir is at the MAX (upper) level line (A).

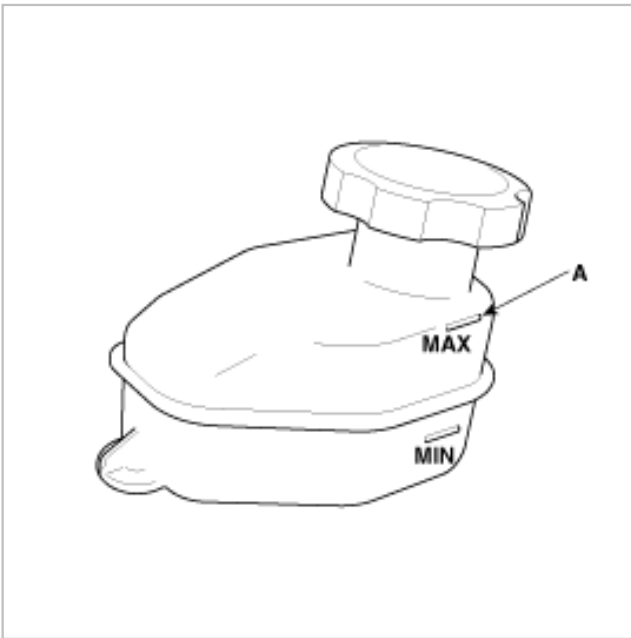

2. Have someone slowly pump the brake pedal several times, then apply steady pressure.
3. Loosen the right-rear brake bleed screw to allow air to escape from the system. Then tighten the bleed screw securely.
4. Repeat the procedure for each wheel in the sequence shown below until air bubbles no longer appear in the fluid.
5. Refill the master cylinder reservoir to the MAX (upper) level line.

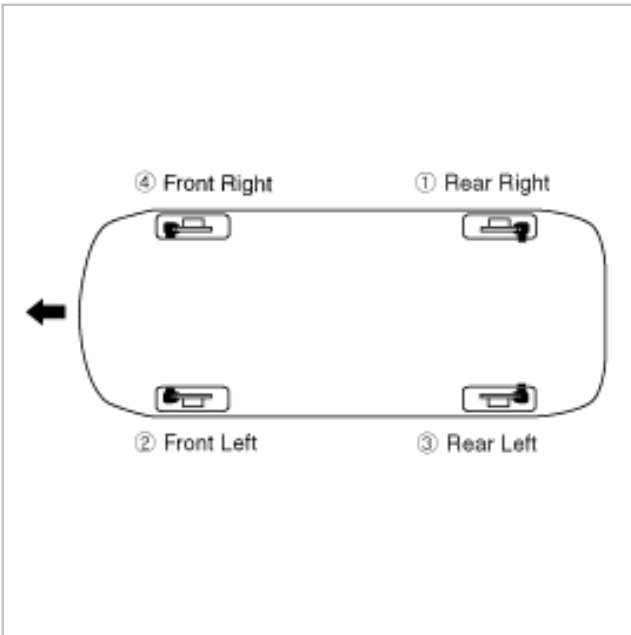

Front disc brake:

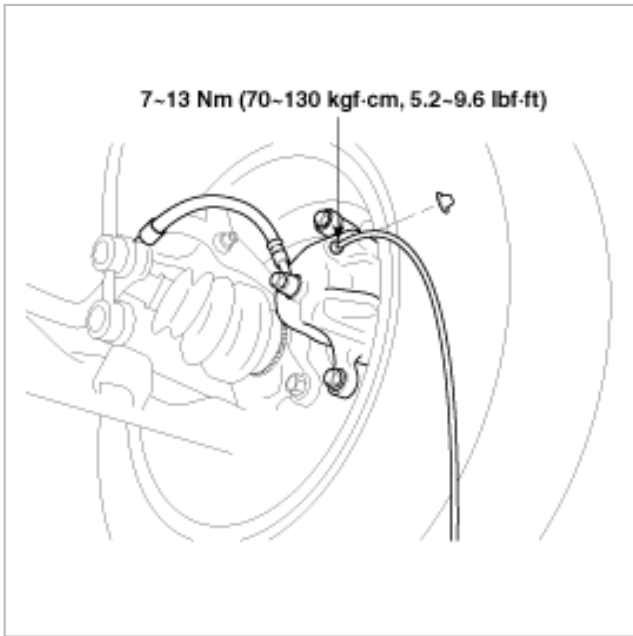

Rear disc brake:

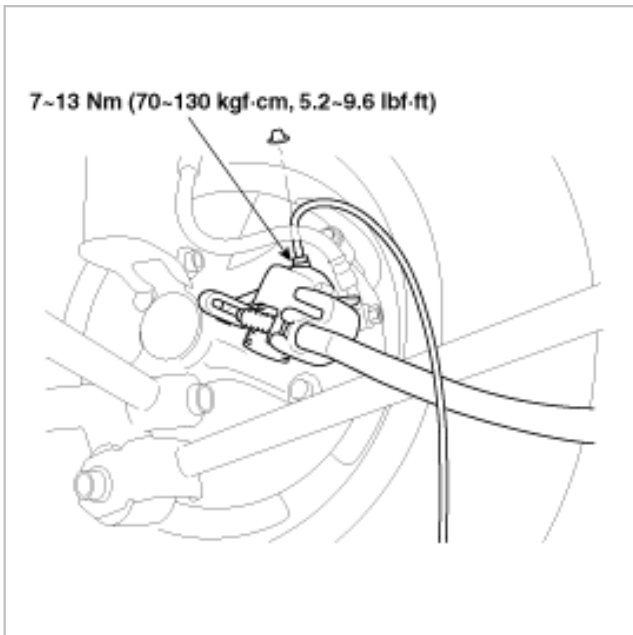

Rear drum brake:

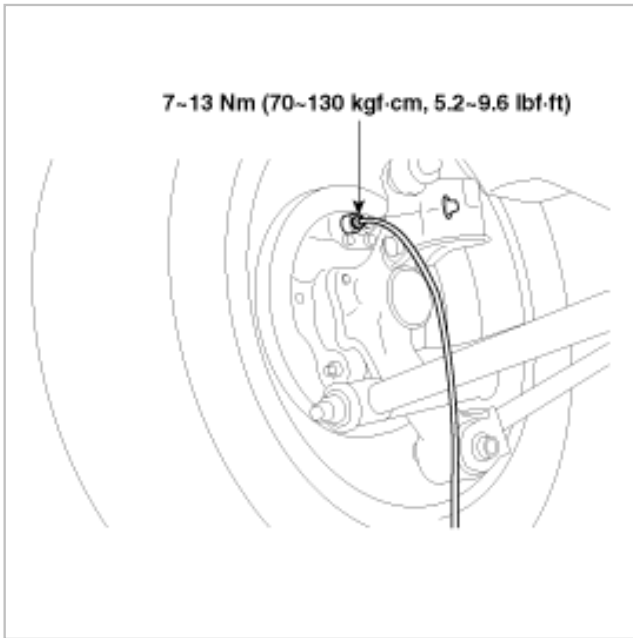

Parking Brake Switch Test

1. Remove the rear console, and disconnect the connector (A) from the switch (B).

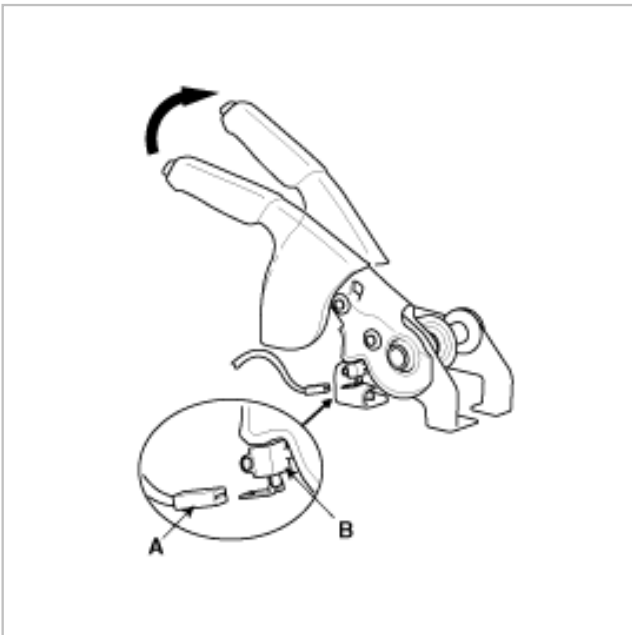

2. Check for continuity between the positive terminal and body ground:
 - A. With the brake lever up, there should be continuity.
 - B. With the brake lever down, there should be no continuity.