

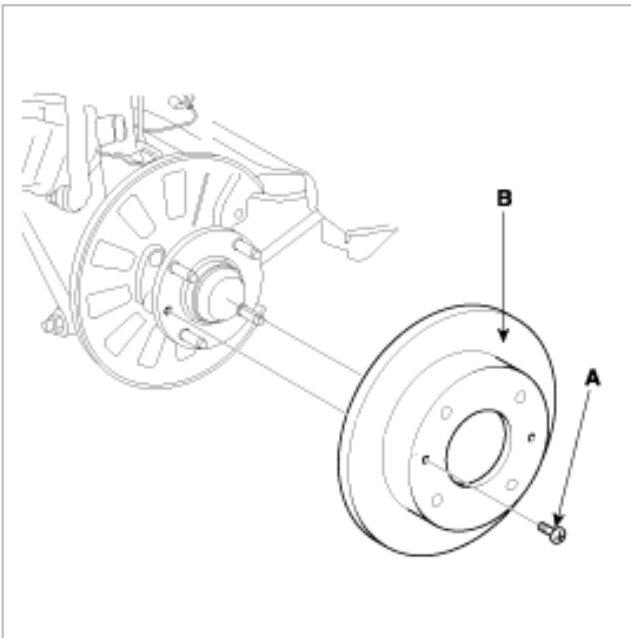

## REMOVAL

1. Loosen the wheel nuts slightly.
2. Raise rear of the vehicle.
3. Loosen the rear wheel nuts thoroughly and remove the rear wheel and tire.
4. Remove the rear wheel hub cap with a screw driver and a hammer.
5. Remove the rear wheel bearing nut and the rear wheel hub washer.
6. Remove the fixed screw (A) of the brake disc (B), and then remove the brake disc (B).

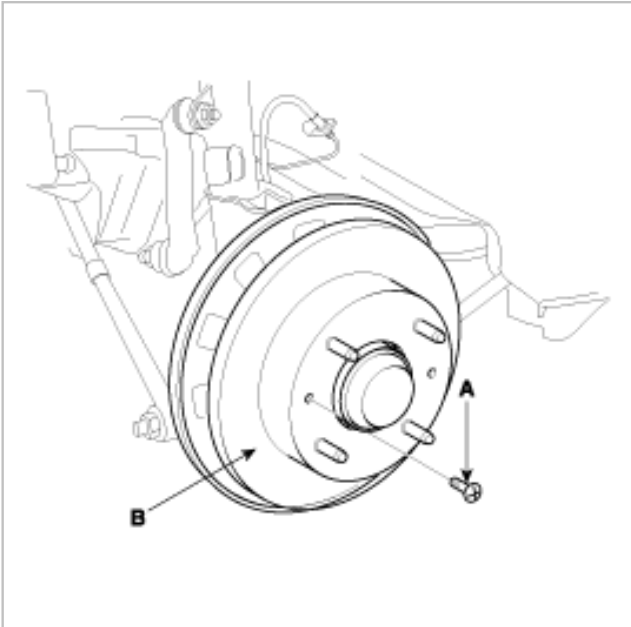

7. Remove the rear wheel speed sensor (for vehicles equipped with Anti-lock Brake System).

8. Remove the bolt(A) and the separate the rear wheel speed sensor(B).

In this case, separate the wheel speed sensor(B) after loosening the lower bolt(E) of two rear strut(C) mounting bolts(D,E).

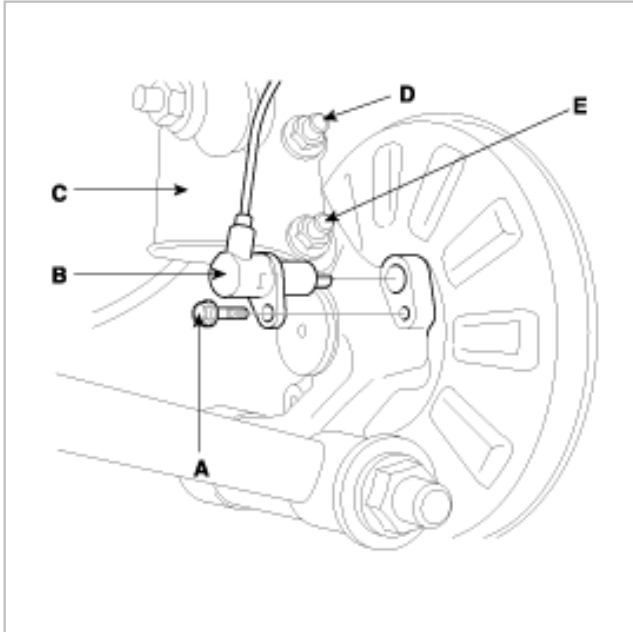

9. Using a flat-tipped screwdriver, remove the wheel hub cap(A).

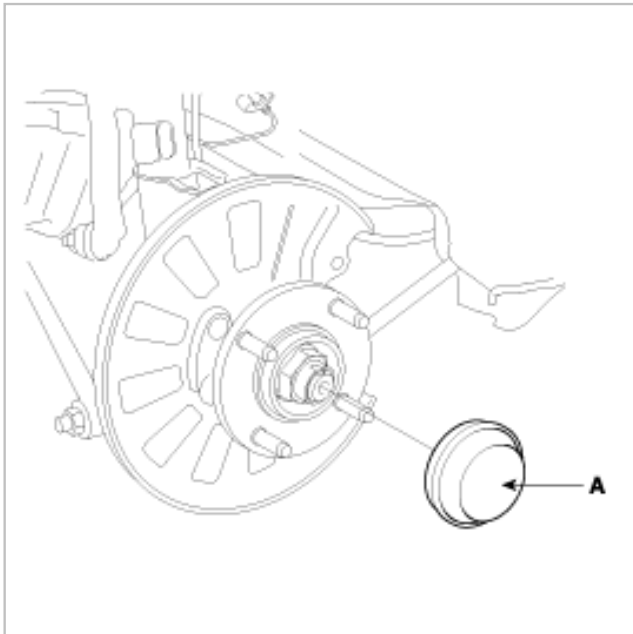

10. Remove the wheel bearing nut(A).

A. Using a flat-tipped (-) screwdriver, spread out the groove(B) on the bearing nut(A).

B. Loosen the wheel bearing nut(A).

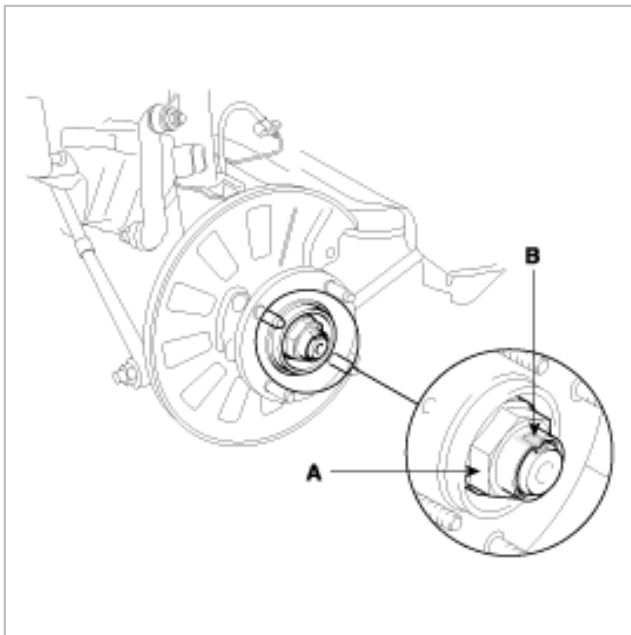

11. Remove the rear wheel hub washer(A).

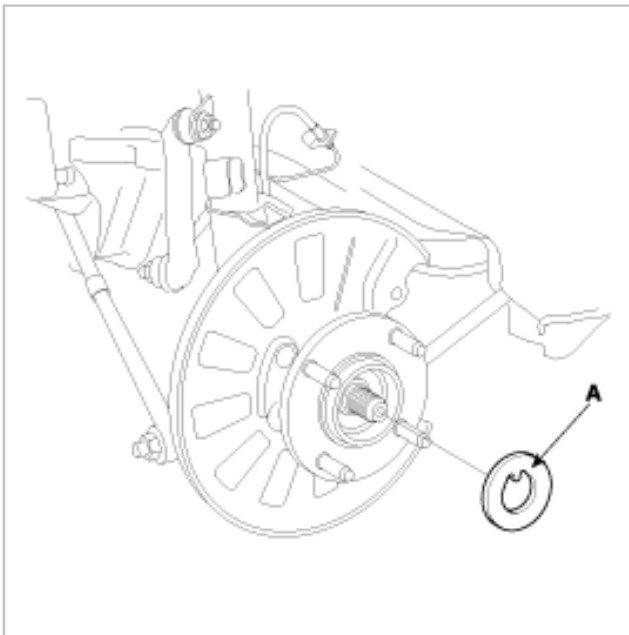

12. Remove the rear wheel hub assembly(A).

Remove the bolts(B) and then remove the dust cover(C).

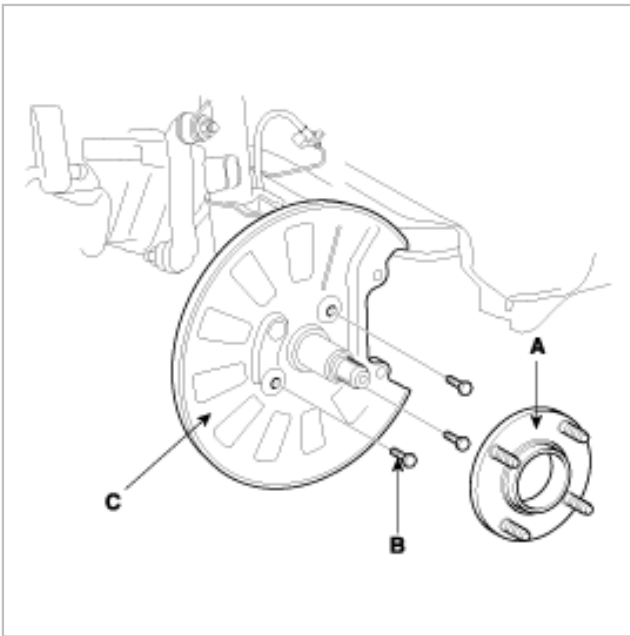

### NOTE

- The rear hub assembly should not be disassembled.
- (For vehicles equipped with ABS)  
Care must be taken not to scratch or damage the teeth of the rotor. The rotor must never be dropped. If the teeth of the rotor are chipped, it results in deformation of the rotor. It will make it impossible to detect the wheel rotation speed accurately and to operate the system normally.

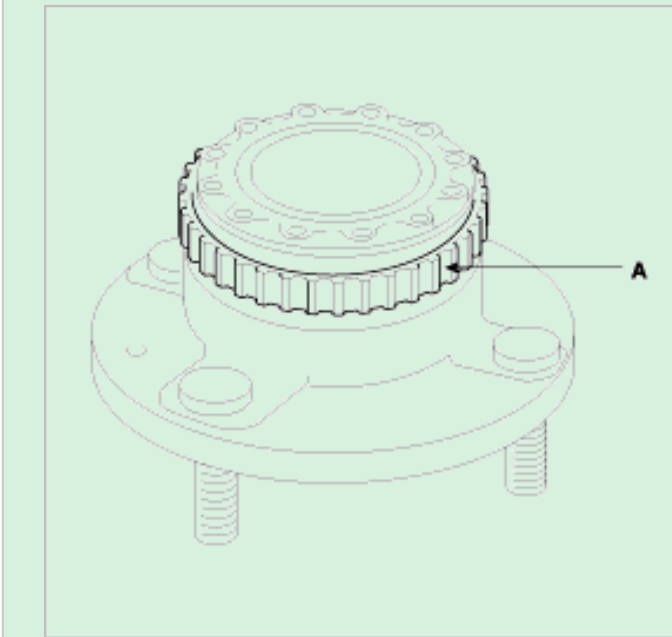

13. Remove the rear dust cover.

14. Remove the rear axle carrier(A).

A. Loosen the 4nuts(B,C,D,E) shown in illustration below.

For the nut D, it may be already loose in removing procedure of the wheel speed sensor.

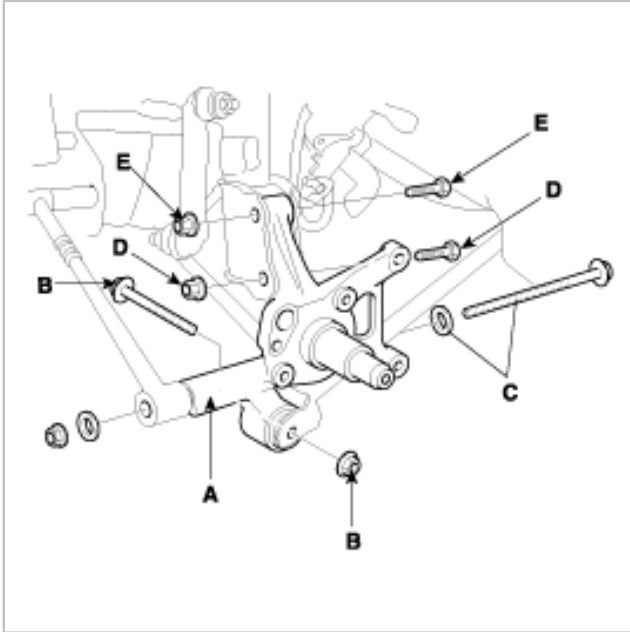

## INSTALLATION

1. After tightening the wheel bearing nut, caulk the concave portion(B) of the spindle(A) by crimping the nut.

### CAUTION

Replace the wheel bearing nut with new ones after removal.

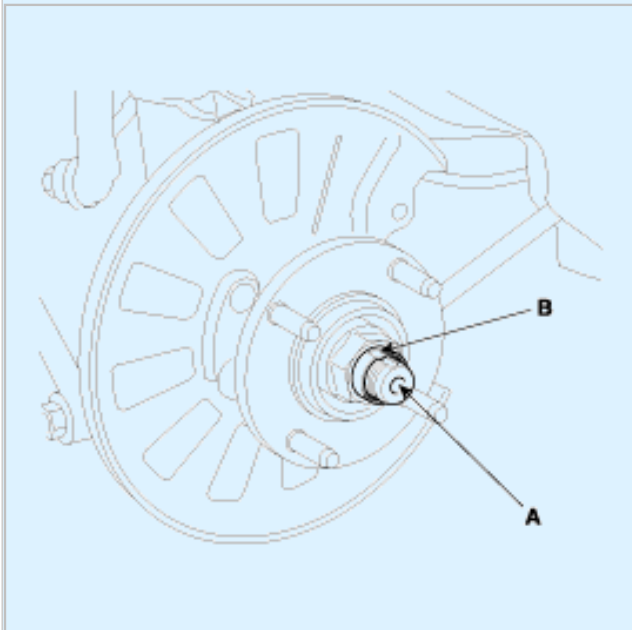

2. Installation of the rear speed sensor(A) (For vehicles equipped with ABS) :

Insert a feeler gauge(C) into the space between the pole piece of the speed sensors(A) and the rotor teeth(B) surface, and then tighten the speed sensors(A) at the position where the clearance at all places is within the standard value.

---

**Standard value**

Clearance : 0.2~1.3 mm (0.008~0.051 in.)

---

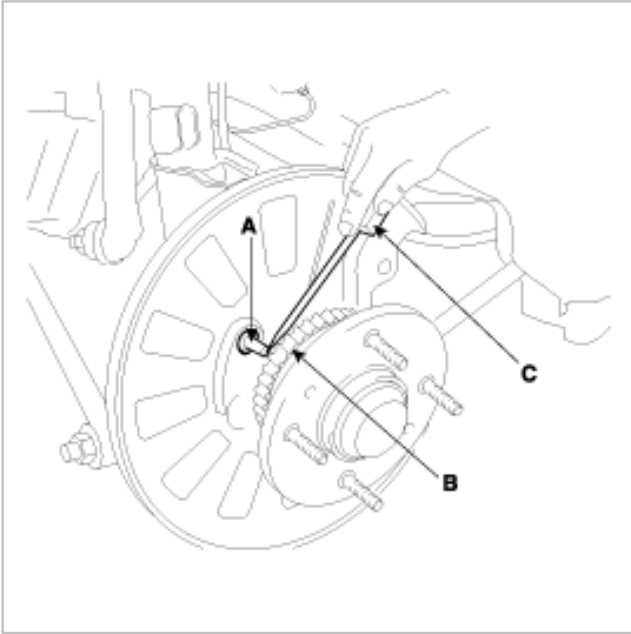

3. Install the hub cap.

## INSPECTION

1. Check the oil seal for cracks or damage.
2. Check the rear hub bearing for wear or damage.
3. Check the rear rotor for chipped teeth.
4. Check the rear carrier for cracks.