

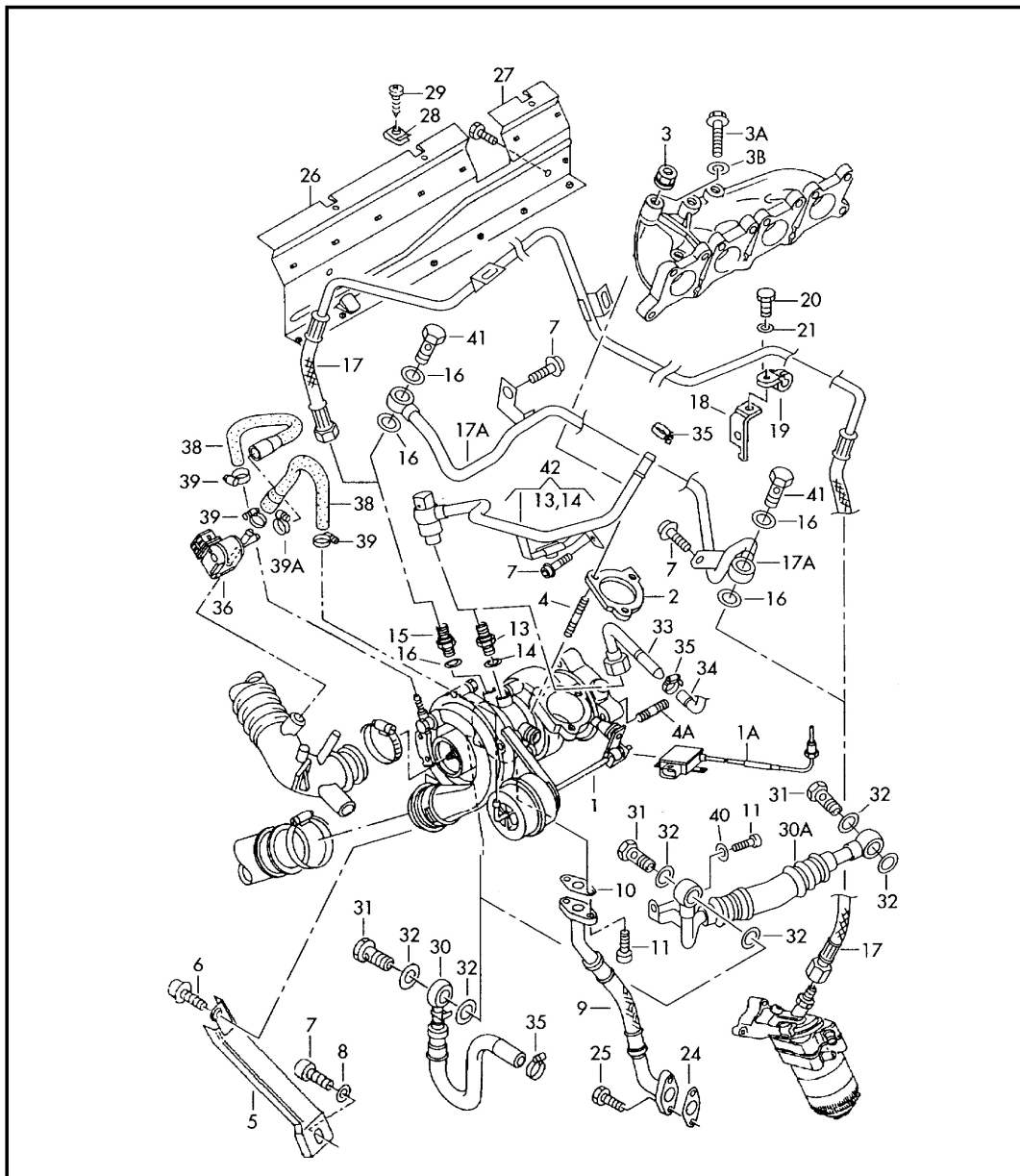

Model	Year	MG	SG	Illustration	Restrictions	UPD	12:52	22.04.2022		ETKA
OCT	2003	1	45	145-50		133				



Pos	Part Number	Name	Remarks	Qty	Model
		turbocharger	1.8ltr.		AGU, AUM, ARX, AUQ
1	06A 145 704 L	turbocharger	KKK also use: N 907 678 01 as required use: 058 145 540 058 145 791	1	AGU
(1)	#06A 145 704 LX	turbocharger	KKK also use: N 907 678 01 as required use: 058 145 540 058 145 791	1	AGU
(1)	>06A 145 713 D	turbocharger	KKK as required use: 06A 145 832 M 06A145867 E/M	1	AUQ, AUM, ARX
		F	>> 1U-7A009 890*	1	
		F	>> 1U-78881 271*	1	
(1)	#06A 145 713 DX	turbocharger	KKK as required use: 06A 145 832 M 06A145867 E/M	1	AUQ, AUM, ARX
		F	>> 1U-7A009 890*	1	
		F	>> 1U-78881 271*	1	
(1)	06A 145 713 F	turbocharger	KKK as required use: 06A 145 832 M 06A145867 E/M	1	AUQ, AUM, ARX
		F	1U-7A009 891>>*	1	
		F	1U-78881 272>>*	1	
2	06A 253 039 E	gasket		1	
3A	058 145 540	screw, hex. hd.	M10X50	3	
3B	058 145 791	washer	10, 4X24X3	3	
4A	N 907 678 01	stud	M10X35	4	
(5)	06A 145 536 B	support part		1	
6	N 010 247 10	bolt, hex. hd., self-locking	M8X35	1	
7	N 103 036 03	socket hd. screw with collar	M8X16	X	
9	06A 145 735 AA	oil return line		1	
(9)	06A 145 735 S	oil return line	4X4	1	
		F	only for: >> 1U-7A009 890*		
		F	>> 1U-78881 271*		

Model	Year	MG	SG	Illustration	Restrictions	UPD	12:52	22.04.2022		ETKA
OCT	2003	1	45	145-50		133				

Pos	Part Number	Name	Remarks	Qty	Model	Pos	Part Number	Name	Remarks	Qty	Model
(9)	06A 145 735 AD	oil return line only for: F 1U-7A009 891>>* F 1U-78881 272>>*	4X4	1		31	N 021 074 2	banjo bolt F >> 1U-3-696 896 F >> 1U-3A006 571 F >> 1U-38675 072	10	2	
10	058 145 757 B	gasket F >> 1U-4-830 086* F >> 1U-48720 053*		1		(31)	06A 145 541 J	banjo bolt F 1U-3-696 897>> F 1U-3A006 572>> F 1U-38675 073>>	10	2	
(10)	058 145 757 C	gasket F 1U-4-830 087>>* F 1U-48720 054>>*		1		32	N 013 814 9	sealing washer F >> 1U-3-696 896 F >> 1U-3A006 571 F >> 1U-38675 072	14X18X1,5	2	
11	N 014 702 10	bolt, with hex. socket hd.	M6X15	X		(32)	N 013 849 5	sealing washer F 1U-3-696 897>> F 1U-3A006 572>> F 1U-38675 073>>	A14X20	2	
13	06A 145 541 H	banjo bolt	M14X1,5X38	1		35	N 102 582 01	clamp	AL12-22	X	
14	N 013 814 9	sealing washer	14X18X1,5	1		36	058 906 283 F	solenoid valve		1	
16	N 013 812 8	sealing washer F >> 1U-3-704 906 F >> 1U-3A006 980 F >> 1U-38677 465	A12X15,5X1,5	X		38	06A 145 712 C	pressure controlline as required use:	8L0 145 718 C 028 145 657 N 020 902 2	1 1 1	
(16)	N 013 851 4	sealing washer F 1U-3-704 907>> F 1U-3A006 981>> F 1U-38677 466>>	A12X18	1		(38)	8L0 145 718 C	pressure controlline as required use:	06A 145 712 C 028 103 657 N 020 902 2	1 1 1	
17A	06A 145 778 D	oil pipe F >> 1U-3-704 906 F >> 1U-3A006 980 F >> 1U-38677 465		1		39	N 024 528 1	clamp	LC8-12	X	
(17A)	06A 145 778 Q	oil pipe F 1U-3-704 907>> F 1U-3A006 981>> F 1U-38677 466>>		1		40	N 012 226 5	spring washer	B6X12X0,5	1	
24	058 145 757 A	gasket		1		41	N 021 071 5	banjo bolt F >> 1U-6A036 517* F >> 1U-68863 540*	LL8	1	
25	N 100 863 02	bolt, with hex. socket hd. (combi.)	M6X22SPZ1	X		(41)	06A 145 541 A	banjo bolt (for turbocharger) F >> 1U-6A036 517* F >> 1U-68863 540*	LL8	1	
30A	06A 121 497 Q	water hose (adapters > turbocharger) also use:	feed N 013 849 5 06A 145 541 J	1		(41)	WHT 000 223	banjo bolt F 1U-6A036 518>>* F 1U-68863 541>>*		1	

Model	Year	MG	SG	Illustration	Restrictions	UPD	12:52	22.04.2022		ETKA
OCT	2003	1	45	145-50		133				

Pos	Part Number	Name	Remarks	Qty	Model	Pos	Part Number	Name	Remarks	Qty	Model
42	06A 121 492 AB	water pipe	return (KOMPLET)	1							
		F >> 1U-4-898 054*									
		F >> 1U-4A019 552*									
		F >> 1U-48745 256*									
42A	06A 121 492 AD	water pipe		1							
		F 1U-4-898 055>>									
		F 1U-4A019 553>> 1U-7A009 890*									
		F 1U-48745 257>> 1U-78881 271*									
		as required use:	06A 145 541 H	*							
			06A 121 279	*							
			N 013 814 9	*							
(42A)	06A 121 492 AG	water pipe		1							
		F 1U-7A009 891>>*									
		F 1U-78881 272>>*									
		as required use:	06A 145 541 H	*							
			06A 121 279	*							
			N 013 814 9	*							
-	06A 121 279	spacer		1							